



- IT** **Decespugliatore/tagliaerba portatile alimentato a batteria**
MANUALE DI ISTRUZIONI - ATTENZIONE: prima di usare la macchina, leggere attentamente il presente libretto.
- BG** **Преносим акумулаторен хросторез/тример**
УПЪТВАНЕ ЗА УПОТРЕБА
ВНИМАНИЕ: преди да използвате машината прочетете внимателно настоящата книжка.
- BS** **Akumulatorski trimer za travu**
UPUTSTVO ZA UPOTREBU
PAŽNJA: prije nego što koristite ovu mašinu, pažljivo pročitajte priručnik s uputama.
- CS** **Přenosný akumulátorový křovinořez/sekačka**
NÁVOD K POUŽITÍ
UPOZORNĚNÍ: před použitím stroje si pozorně přečtěte tento návod k použití.
- DA** **Bærbar, batteridrevet kratrydder/græsskærer**
BRUGSANVISNING
ADVARSEL: læs instruktionsbogen omhyggeligt igennem, før du tager denne maskine i brug.
- DE** **Tragbarer Freischneider/Rasenmäher mit Batteriebetrieb**
GEBRAUCHSANWEISUNG
ACHTUNG: Vor Inbetriebnahme des Geräts die Gebrauchsanleitung aufmerksam lesen.
- EL** **Φορητό θαμνοκοπτικό/χλοοκοπτικό μπαταρίας**
ΟΔΗΓΙΕΣ ΧΡΗΣΗΣ
ΠΡΟΣΟΧΗ: πριν χρησιμοποιήσετε το μηχάνημα, διαβάστε προσεκτικά το παρόν εγχειρίδιο.
- EN** **Battery powered portable brush cutter/lawn trimmer**
OPERATOR'S MANUAL
WARNING: read thoroughly the instruction booklet before using the machine.
- ES** **Desbrozadora/cortadora de pasto portátil alimentada a batería**
MANUAL DE INSTRUCCIONES
ATENCIÓN: antes de utilizar la máquina, leer atentamente el presente manual.
- ET** **Kaasaskantav akutoitel võsalõikur/murutrimmer**
KASUTUSJUHEND
TÄHELEPANU: enne masina kasutamist lugeda tähelepanelikult antud kasutusjuhendit.
- FI** **Käsin kannateltava akkukäyttöinen raivaussaha/ruohonleikkuri**
KÄYTTÖOHJEET
VAROITUS: lue käyttöopas huolellisesti ennen koneen käyttöä
- FR** **Débroussaileur/coupe-herbe portatif alimenté par batterie**
MANUEL D'UTILISATION
ATTENTION: lire attentivement le manuel avant d'utiliser cette machine.
- HR** **Prijenošni čistač šikare/šišač trave s baterijskim napajanjem**
PRIRUČNIK ZA UPORABU
POZOR: prije uporabe stroja, pažljivo pročitajte ovaj priručnik.
- HU** **Hordozható akkumulátoros bozótirtó/fűnyíró**
HASZNÁLATI UTASÍTÁS
FIGYELEM! a gép használatá elött olvassa el figyelmesen a jelen kézikönyvet.
- LT** **Rankinė akumuliatorinė krūmapjovė/zoliapjovė**
NAUDOJIMO INSTRUKCIJOS
DĖMESIO: prieš naudojant įrenginį, atidžiai perskaityti šį naudotojo vadovą.
- LV** **Pārnesams krūmgriezis/plaujmašīna ar akumulatora barošanu**
LIETOŠANAS INSTRUKCIJA
UZMANĪBU: pirms aparāta lietošanai rūpīgi izlasiet doto instrukciju.
- MK** **Преносен потнаструвач/тревокосачка со напојување на батерија**
УПАТСТВА ЗА УПОТРЕБА
ВНИМАНИЕ: прочитајте го внимателно ова упатство пред да ја користите машината.
- NL** **Draagbare bosmaaier/trimmer met accutoevoer**
GEBRUIKERSHANDLEIDING
LET OP: vooraleer de machine te gebruiken, dient men deze handleiding aandachtig te lezen.
- NO** **Bærbar batteridrevet gresstrimmer/gressklipper**
INSTRUKSJONSBOK
ADVARSEL: les denne bruksanvisningen nøye før du bruker maskinen.

- PL** Przenośna, akumulatorowa podkaszarka/podcinarka
INSTRUKCJE OBSŁUGI
OSTRZEŻENIE: przed użyciem maszyny, należy uważnie przeczytać niniejszą instrukcję.
- PT** Roçadeira/aparador de relva portátil alimentado a bateria
MANUAL DE INSTRUÇÕES
ATENÇÃO: antes de usar a máquina, leia atentamente o presente manual.
- RO** Maşină de tăiat arboret/maşină de tuns iarba portabilă alimentată cu baterie
MANUAL DE INSTRUCȚIUNI
ATENȚIE: înainte de a utiliza maşina, citiţi cu atenţie manualul de faţă.
- RU** Переносной нусторез/газоносоилка с батарейным питанием
РУКОВОДСТВО ПО ЭКСПЛУАТАЦИИ
ВНИМАНИЕ: прежде чем пользоваться оборудованием, внимательно прочтите это руководство по эксплуатации.
- SK** Prenosný akumulátorový krovínorez/kosačka
NÁVOD NA POUŽITIE
UPOZORNENIE: pred použitím stroja si pozorne prečítajte tento návod.
- SL** Prenosna akumulatorska kosa/obrezovalnik trat
PRIROČNIK ZA UPORABO
POZOR: preden uporabite stroj, pazljivo preberite priročnik z navodili.
- SR** Akumulatorski trimer za travu
PRIRUČNIK SA UPUTSTVIMA
PAŽNJA: pre korišćenja mašine pažljivo pročitati ovaj priručnik.
- SV** Bärbar batteridrivnen röjsåg/gräsklippare
BRUKSANVISNING
VARNING: läs igenom hela detta häfte innan du använder maskinen.
- TR** Batarya beslemeli taşınabilir çalı biçme/kenar kesme makinesi
KULLANIM KILAVUZU
DİKKAT: makineyi kullanmadan önce talimatlar içeren kilavuzu dikkatle okuyun.

ITALIANO - Istruzioni Originali	IT
БЪЛГАРСКИ - Превод на оригиналните инструкции	BG
BOSANSKI - Prijevod originalnih uputa	BS
ČESKY - Překlad původního návodu k používání	CS
DANSK - Oversættelse af den originale brugsanvisning	DA
DEUTSCH - Übersetzung der Originalbetriebsanleitung	DE
ΕΛΛΗΝΙΚΑ - Μετάφραση του πρωτοτύπου των οδηγιών χρήσης	EL
ENGLISH - Translation of the original instruction	EN
ESPAÑOL - Traducción del Manual Original	ES
EESTI - Algupärase kasutusjuhendi tõlge	ET
SUOMI - Alkuperäisten ohjeiden käännös	FI
FRANÇAIS - Traduction de la notice originale	FR
HRVATSKI - Prijevod originalnih uputa	HR
MAGYAR - Eredeti használati utasítás fordítása	HU
LIETUVIŠKAI - Originalių instrukcijų vertimas	LT
LATVIEŠU - Instrukciju tulkojums no oriģinālvalodas	LV
МАКЕДОНСКИ -Превод на оригиналните упатства	MK
NEDERLANDS - Vertaling van de oorspronkelijke gebruiksaanwijzing	NL
NORSK - Oversettelse av original bruksanvisning	NO
POLSKI - Tłumaczenie instrukcji oryginalnej	PL
PORTUGUÊS - Tradução do manual original	PT
ROMÂN - Traducerea manualului fabricantului	RO
РУССКИЙ - Перевод оригинальных инструкций	RU
SLOVENŠČINA - Prevod izvirnih navodil	SL
SLOVENSKY - Preklad pôvodného návodu na použitie	SK
SRPSKI - Prevod originalnih uputstva	SR
SVENSKA - Översättning av bruksanvisning i original	SV
TÜRKÇE - Orijinal Talimatların Tercümesi	TR

1

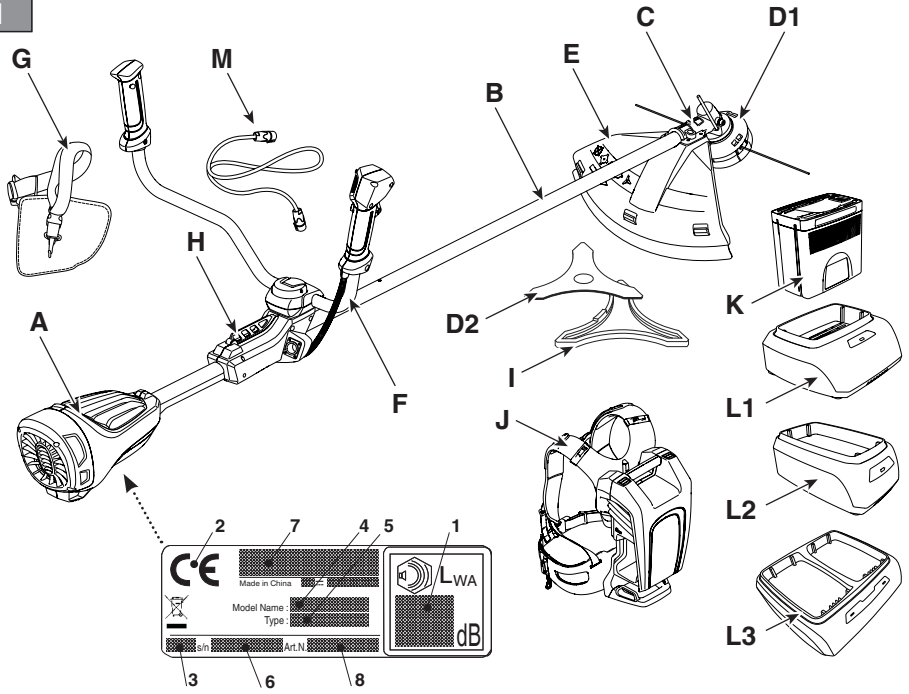

2

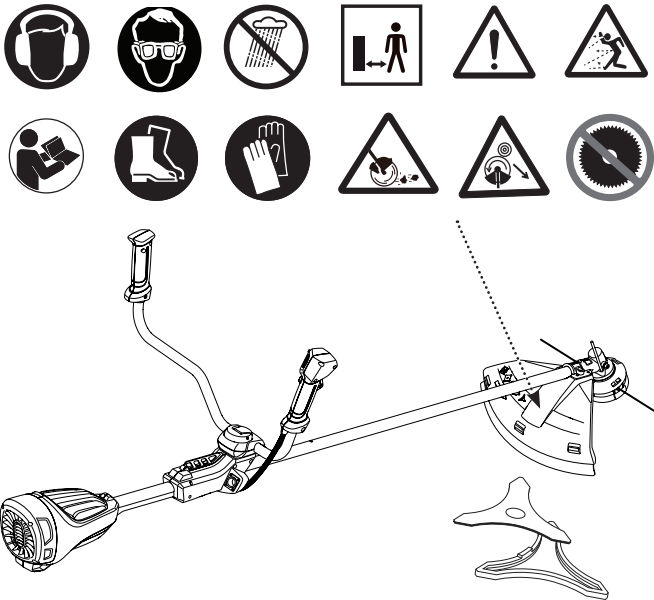

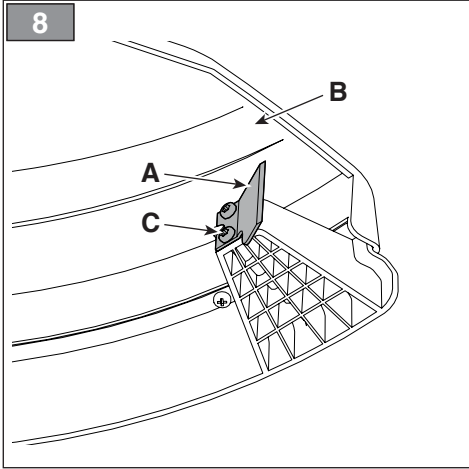
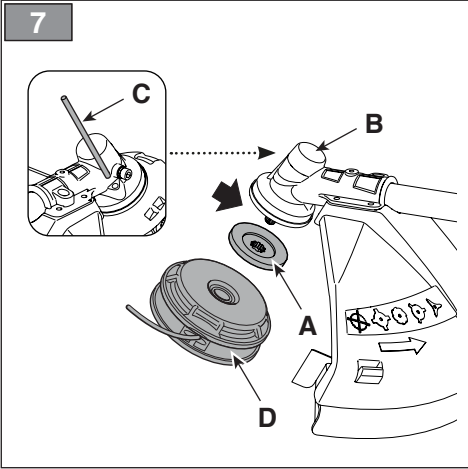
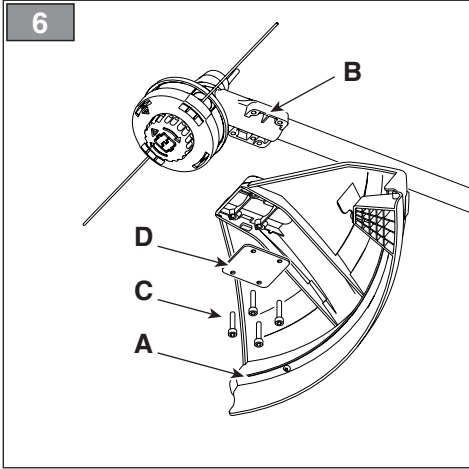
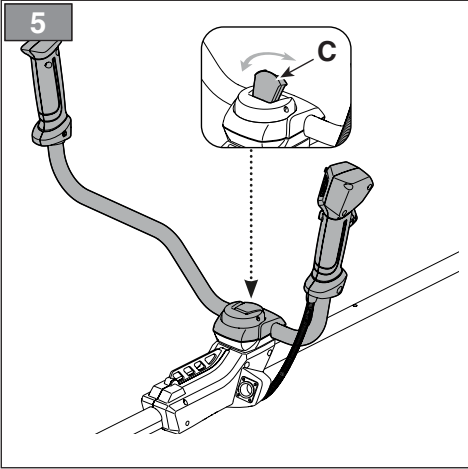
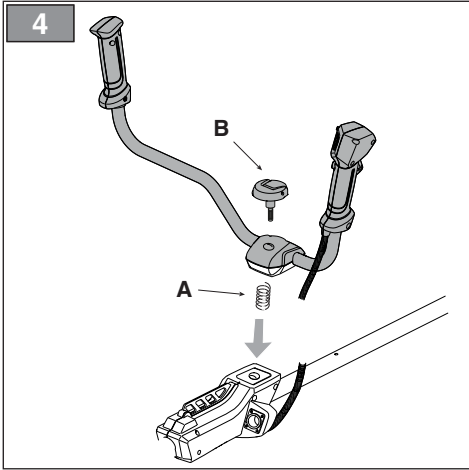
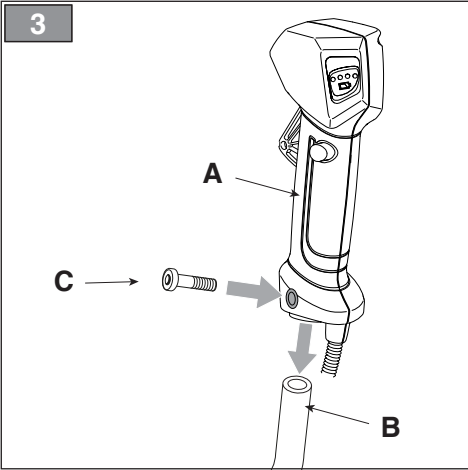

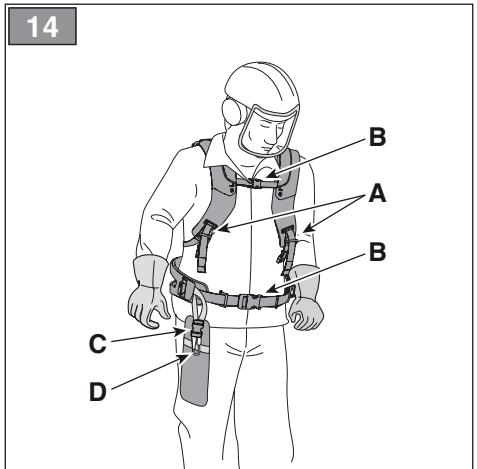
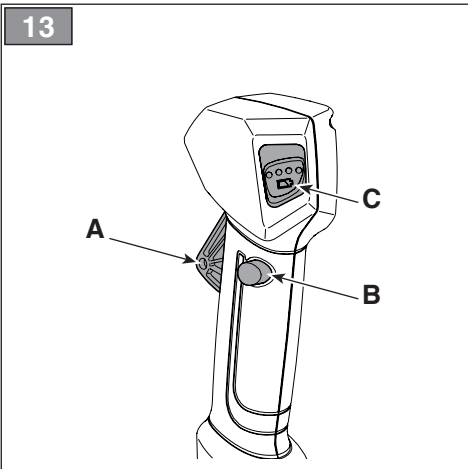
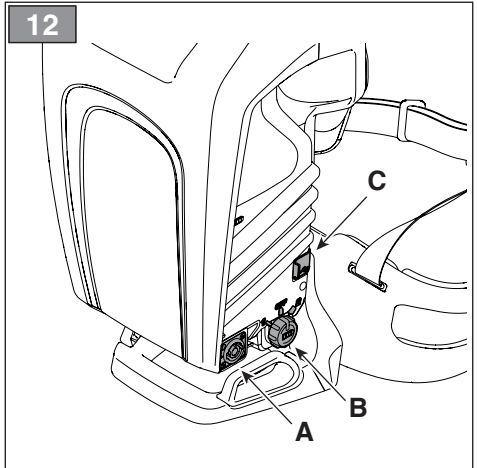
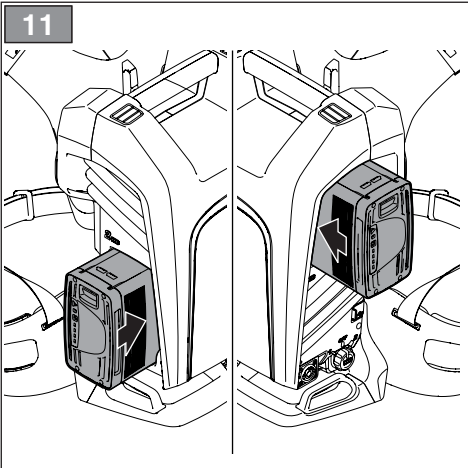
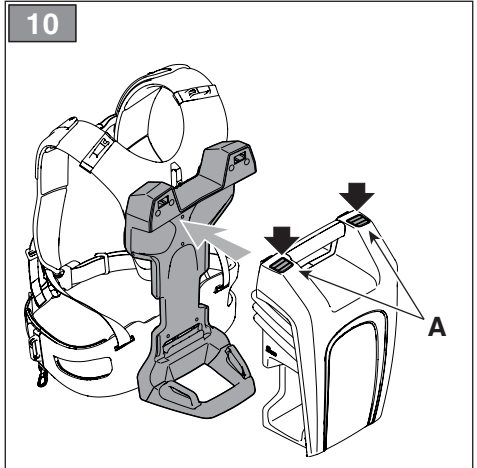
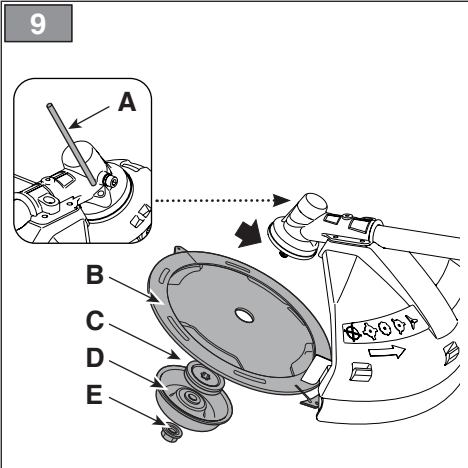

15

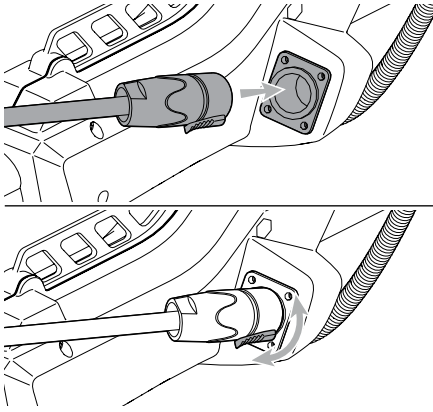

16



17

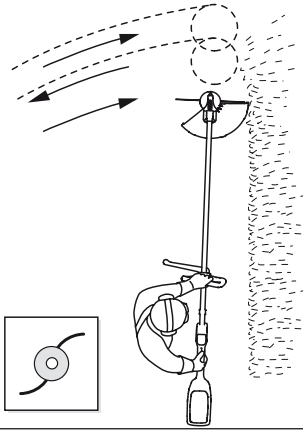

18

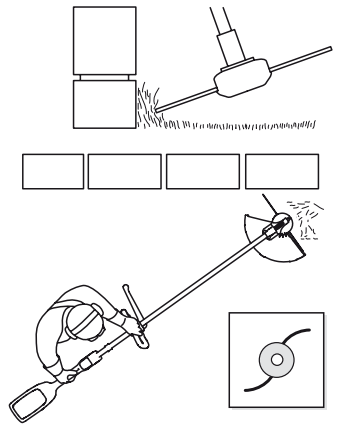

19

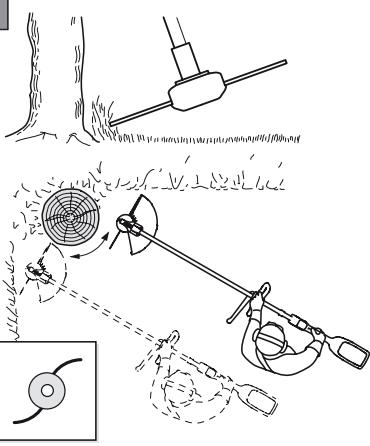

20

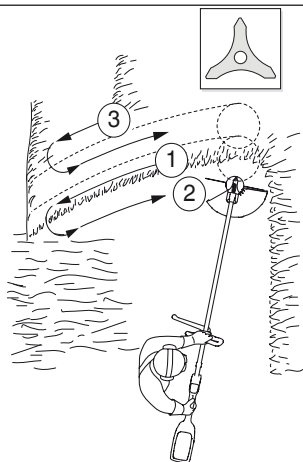

21

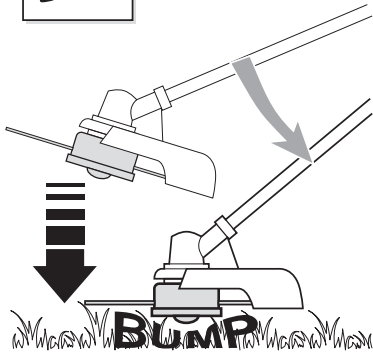
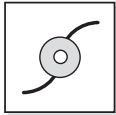

22

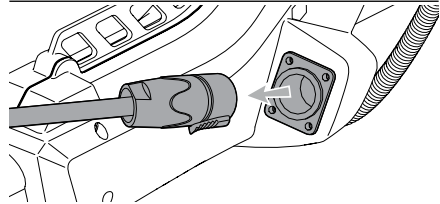
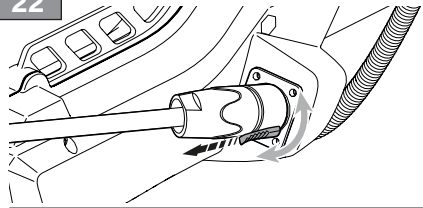

23

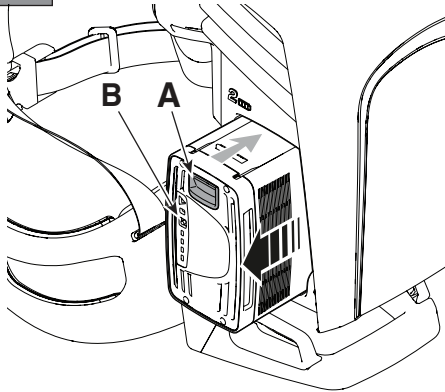

24

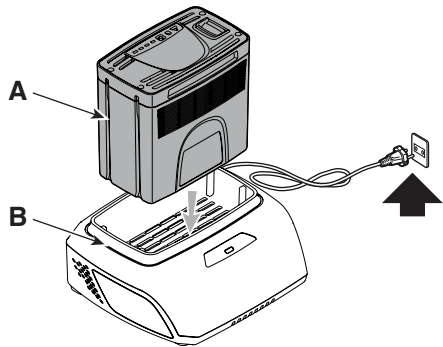

25

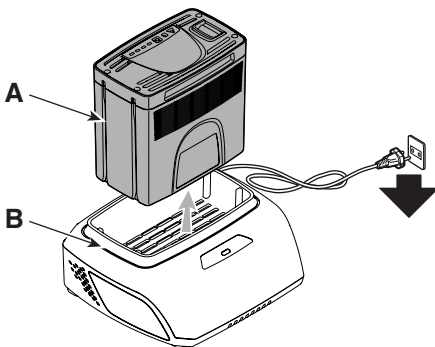

26

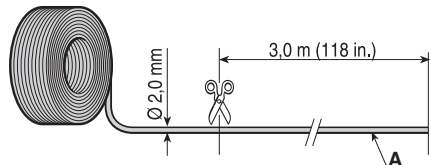

27

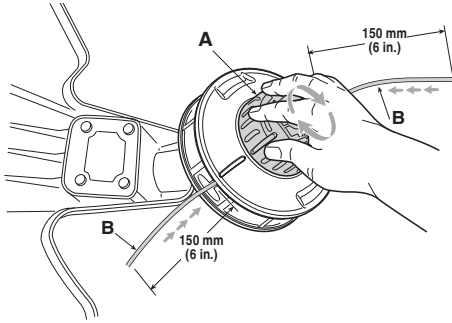

28

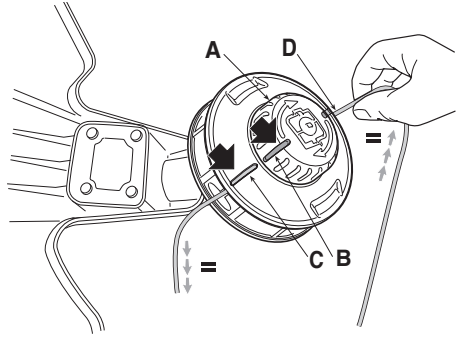

27

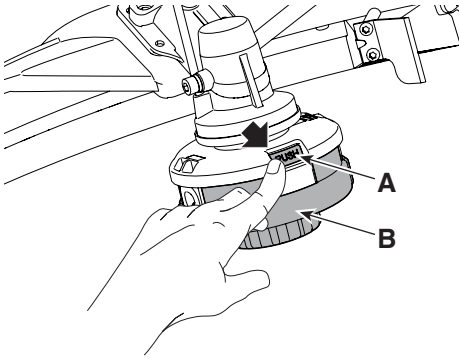

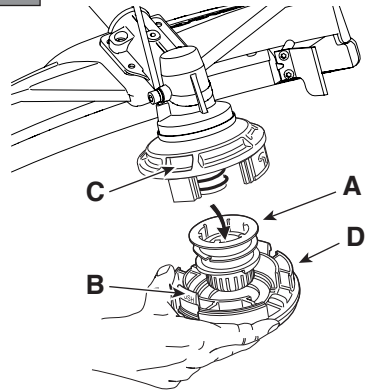

28

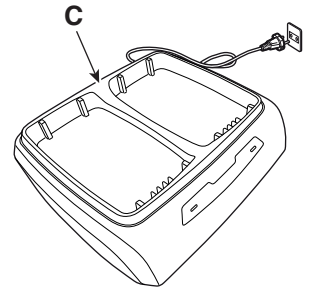
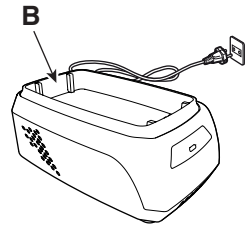
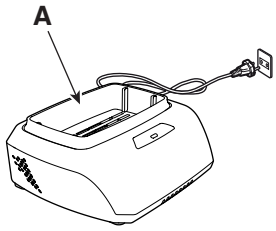

29



[1]	DATI TECNICI		BC 900 D Li 48
[2]	Tensione di alimentazione MAX	V / DC	48
[3]	Tensione di alimentazione NOMINAL	V / DC	43,2
[4]	Velocità massima di rotazione dell'utensile (testina porta filo)	min ⁻¹	6200 ± 10%
[5]	Velocità massima di rotazione dell'utensile (lama a 4 punte)	min ⁻¹	6200 ± 10%
[6]	Larghezza di taglio (testina porta filo)	mm	430
[7]	Larghezza di taglio (lama a 3 punte)	mm	255
[8]	Attacco testina porta filo		M10x1,25 sx F
[9]	Diametro filo testina (max)	mm	2,5
[10]	Codice dispositivo di taglio		118805046/0
[10]	Codice dispositivo di taglio		118805533/0, 255 mm
[11]	Codice protezione		118805553/0
[12]	Peso	kg	5,6
[13]	Tensione e corrente di carica (Uscita USB)	V / A	5 / 2
[14]	Tagliabordi		
[15]	Livello di pressione sonora (in base alla ISO 3744:2010)	dB(A)	81,9
[16]	Incertezza di misura	dB(A)	3
[17]	Livello di potenza sonora misurato (in base alla ISO 3744:2010)	dB(A)	93,4
[16]	Incertezza di misura	dB(A)	2,22
[18]	Livello di potenza sonora garantito (in base alla 2000/14/EC)	dB(A)	96
[19]	Decespugliatore		
[15]	Livello di pressione sonora (in base alla ISO 3744:2010)	dB(A)	81,3
[16]	Incertezza di misura	dB(A)	3
[17]	Livello di potenza sonora misurato (in base alla ISO 3744:2010)	dB(A)	91,3
[16]	Incertezza di misura	dB(A)	3,37
[18]	Livello di potenza sonora garantito (in base alla 2000/14/EC)	dB(A)	95
[20]	Vibrazioni trasmesse alla mano sull'impugnatura anteriore (in base alla ISO 3744:2010)	m/s ²	1,92
[16]	Incertezza di misura		1,5
[21]	Vibrazioni trasmesse alla mano sull'impugnatura posteriore (in base alla ISO 3744:2010)	m/s ²	2,39
[16]	Incertezza di misura		1,5

[22]	ACCESSORI A RICHIESTA	
[23]	Gruppo batteria, mod.	BT 520 Li 48 BT 540 Li 48 BT 550 Li 48 BT 740 Li 48 BT 740 Li 48 BT 750 Li 48 BT 775 Li 48
[24]	Carica batteria	CG 500 Li 48 CGF 500 Li 48 CGD 500 Li 48 CG 700 Li 48 CGF 700 Li 48 CGD 700 Li 48
[25]	Zaino portabatterie	√

a) NOTA: il valore totale dichiarato delle vibrazioni è stato misurato attenendosi ad un metodo normalizzato di prova e può essere utilizzato per fare un paragone tra un utensile e l'altro. Il valore totale delle vibrazioni può essere utilizzato anche in una valutazione preliminare dell'esposizione.

b) AVVERTENZA: l'emissione di vibrazioni nell'uso effettivo dell'utensile può essere diversa dal valore totale dichiarato a seconda dei modi in cui si utilizza l'utensile. Pertanto è necessario, durante il lavoro, adottare le seguenti misure di sicurezza volte a proteggere l'operatore: indossare guanti durante l'uso, limitare i tempi d'utilizzo della macchina e accorciare i tempi in cui si tiene premuta la leva comando acceleratore.

<p>[1] BG - ТЕХНИЧЕСКИ ДАННИ</p> <p>[2] Захранващо напрежение МАКС</p> <p>[3] Захранващо напрежение НОМИНАЛНО</p> <p>[4] Максимална ротационна скорост на инструмента (глава за корда)</p> <p>[5] Максимална ротационна скорост на инструмента (резец с 4 върха)</p> <p>[6] Ширина на рязане (глава за корда)</p> <p>[7] Ширина на рязане (резец с 4 върха)</p> <p>[8] Връзка за глава за корда</p> <p>[9] Диаметър за глава за корда (max)</p> <p>[10] Код на инструмента за рязане</p> <p>[11] Код на защитата</p> <p>[12] Тегло</p> <p>[13] Напрежение и ток на зареждане (На изход USB)</p> <p>[14] Косачка</p> <p>[15] Ниво на звуковото налягане (съгласно ISO 3744:2010)</p> <p>[16] Несигурност на измерване</p> <p>[17] Ниво на измерената звукова мощност (съгласно ISO 3744:2010)</p> <p>[18] Гарантирано ниво на звукова мощност (съгласно 2000/14/EC)</p> <p>[19] Тример</p> <p>[20] Вибрации, предадени на ръката върху предна дръжка (съгласно ISO 3744:2010)</p> <p>[21] Вибрации, предадени на ръката върху задна дръжка (съгласно ISO 3744:2010)</p> <p>[22] Принадлежности по поръчка</p> <p>[23] Акумулаторен блок</p> <p>[24] Зарядно устройство за акумулатора</p> <p>[25] Раница за помещаване на акумулатора</p> <p>a) ЗАБЕЛЕЖКА: декларираната обща стойност на вибрации е измерена придържайки се към стандартизиран метод на изпитване и може да се използва за правене на сравнение между един и друг инструмент. Общата стойност на вибрации може да се използва и за предварителна оценка на излагането.</p> <p>b) ПРЕДУПРЕЖДЕНИЕ: издаването на вибрации при реалното използване на инструмента може да бъде различна от общата декларирана стойност, в зависимост от начините на използване на инструмента. Поради това е необходимо по време на работа да се вземат следните предпазни мерки целящи предпазването на оператора: носете ръкавици по време на използването, ограничете времената на използване на машината и намалете времената, през които се държи натиснат лоста за управление на ускорителя.</p>	<p>[1] BS - TEHNIČKI PODACI</p> <p>[2] MAKS. napon napajanja</p> <p>[3] NOMINALNI napon napajanja</p> <p>[4] Maksimalna brzina okretanja alatke (glava s reznom niti)</p> <p>[5] Maksimalna brzina okretanja alatke (trokrako sječivo)</p> <p>[6] Širina reza (glava s reznom niti)</p> <p>[7] Širina reza (trokrako sječivo)</p> <p>[8] Priključak za glavu s reznom niti</p> <p>[9] Promjer niti glave (maks.)</p> <p>[10] Šifra rezne glave</p> <p>[11] Šifra štinitika</p> <p>[12] Težina</p> <p>[13] Napon i struja punjenja (izlaz USB)</p> <p>[14] Maksimalna: (Trimer)</p> <p>[15] Razina zvučnog pritiska (na osnovu standarda ISO 3744:2010)</p> <p>[16] Mjerna nesigurnost</p> <p>[17] Izmjerena razina zvučne snage (na osnovu standarda ISO 3744:2010)</p> <p>[18] Garantirana razina zvučne snage (na osnovu standarda 2000/14/EC)</p> <p>[19] Šišač za travu</p> <p>[20] Vibracije koje se prenose na ruku na prednjem rukohvatu (na osnovu standarda ISO 3744:2010)</p> <p>[21] Vibracije koje se prenose na ruku na zadnjem rukohvatu (na osnovu standarda ISO 3744:2010)</p> <p>[22] Dodatna oprema na zahtjev</p> <p>[23] Baterija</p> <p>[24] Punjač baterije</p> <p>[25] Ruksak akumulator</p> <p>a) NAPOMENA: ukupna prijavljena vrijednost vibracija izmjerena je prema normalizovanoj metodi ispitivanja i može se koristiti za vršenje poređenja između dvije alatke. Ukupna vrijednost vibracija može se koristiti i prilikom prethodne procjene izloženosti.</p> <p>b) UPOZORENJE: emisija vibracija prilikom stvarne upotrebe alatke može se razlikovati od ukupne prijavljene vrijednosti u zavisnosti od načina na koji se koristi alatka. Stoga je neophodno, za vrijeme rada, primijeniti sljedeće sigurnosne mjere za zaštitu radnika: koristiti rukavice za vrijeme upotrebe, ograničiti vrijeme upotrebe mašine i skratiti vrijeme za koje se drži pritisnuta poluga komande gasa.</p>	<p>[1] CS - TECHNICKÉ PARAMETRY</p> <p>[2] Napájecí napětí MAX</p> <p>[3] Napájecí napětí NOMINAL</p> <p>[4] Maximální rychlost otáčení nástroje (strunová hlava)</p> <p>[5] Maximální rychlost otáčení nástroje (trojzubec)</p> <p>[6] Záběr (strunová hlava)</p> <p>[7] Záběr (trojzubec)</p> <p>[8] Uchytí strunové hlavy</p> <p>[9] Průměr struny (max.)</p> <p>[10] Kód sekacího zařízení</p> <p>[11] Kód ochranného krytu</p> <p>[12] Hmotnost</p> <p>[13] Nabíjecí napětí a proud (výstup USB)</p> <p>[14] Ořezávač okrajů trávníku</p> <p>[15] Úroveň akustického tlaku (dle ISO 3744:2010)</p> <p>[16] Nepřesnost měření</p> <p>[17] Naměřená hladina akustického výkonu (dle ISO 3744:2010)</p> <p>[18] Zaručená úroveň akustického výkonu (dle 2000/14/EC)</p> <p>[19] Ruční přenosný</p> <p>[20] Vibrace přenášené na ruku na přední rukojeti (dle ISO 3744:2010)</p> <p>[21] Vibrace přenášené na ruku na zadní rukojeti (dle ISO 3744:2010)</p> <p>[22] Přislušenství na požádání</p> <p>[23] Akumulátor</p> <p>[24] Nabíječka akumulátorů</p> <p>[25] Batoh s akumulátorem</p> <p>a) POZNÁMKA: prohlášená celková hodnota vibrací byla naměřena s použitím normalizované zkušební metody a lze ji použít pro srovnání jednotlivých nástrojů. Celková hodnota vibrací může být použita také při přípravném vyhodnocování vystavení vibracím.</p> <p>b) VAROVÁNÍ: emise vibrací při skutečném použití nástroje může být odlišná od deklarované celkové hodnoty v závislosti na režimech, ve kterých se daný nástroj používá. Proto je třeba během práce přijmout níže uvedená bezpečnostní opatření, jejichž cílem je ochránit operátora: během běžného použití mějte nasazené rukavice a omezte dobu použití stroje a zkratěte dobu, během kterých je zatlačena ovládací páka plynu.</p>
--	--	---

<p>[1] DA - TEKNISKE DATA</p> <p>[2] Forsyningsspænding MAX</p> <p>[3] Forsyningsspænding NOMINAL</p> <p>[4] Maksimalt omdrejningstal for redskabet (trådhoved)</p> <p>[5] Maksimalt omdrejningstal for redskabet (4-tands klinger)</p> <p>[6] Skærebredde (trådhoved)</p> <p>[7] Skærebredde (4-tands klinger)</p> <p>[8] Montering af trådhoved</p> <p>[9] Diameter af tråd i hovedet (maks.)</p> <p>[10] Skæreanordningens varenr.</p> <p>[11] Beskyttelsens varenummer</p> <p>[12] Vægt</p> <p>[13] Spænding og opladningsstrøm (udgang USB)</p> <p>[14] Plæneklipper</p> <p>[15] Lydtryksniveau (i henhold til ISO 3744:2010)</p> <p>[16] Måleusikkerhed</p> <p>[17] Målt lydeffektivniveau (i henhold til ISO 3744:2010)</p> <p>[18] Garanteret lydeffektivniveau (i henhold til 2000/14/EC)</p> <p>[19] Kratrydder</p> <p>[20] Vibrationer overført til hånden på forreste håndtag (i henhold til ISO 3744:2010)</p> <p>[21] Vibrationer overført til hånden på bagerste håndtag (i henhold til ISO 3744:2010)</p> <p>[22] Ekstraudstyr</p> <p>[23] Batteri</p> <p>[24] Batterioplader</p> <p>[25] Batterirygsæk</p> <p>a) BEMÆRK: den samlede erklærede værdi af vibrationer blev målt ifølge en standardiseret metode til afprøvning og kan bruges til at foretage en sammenligning mellem forskellige redskaber. Den samlede værdi af vibrationer kan også bruges til en indledende vurdering af eksponeringen.</p> <p>b) ADVARSEL: den faktiske udsendelse af vibrationer i forbindelse med brug af redskabet kan afvige fra den samlede attesterede værdi afhængigt af den konkrete brug af redskabet. Derfor er det nødvendigt, at man under arbejdet tager følgende sikkerhedsforanstaltninger for at beskytte brugerne. Bær handsker under brug, begræns den tid maskinen bruges og forkort den tid hvor gashåndtaget holdes aktiveret.</p>	<p>[1] DE - TECHNISCHE DATEN</p> <p>[2] MAX Versorgungsspannung</p> <p>[3] NOMINALE Versorgungsspannung</p> <p>[4] Maximale Drehgeschwindigkeit des Werkzeugs (Fadenkopf)</p> <p>[5] Maximale Drehgeschwindigkeit des Werkzeugs (4-schneidiges Messer)</p> <p>[6] Schnittbreite (Fadenkopf)</p> <p>[7] Schnittbreite (4-schneidiges Messer)</p> <p>[8] Anschluss Fadenkopf</p> <p>[9] Durchmesser Faden Fadenkopf (max.)</p> <p>[10] Code Messer</p> <p>[11] Nummer Schutzeinrichtung</p> <p>[12] Gewicht</p> <p>[13] Ladespannung und -strom (Ausgang USB)</p> <p>[14] Rasentrimmer</p> <p>[15] Schalldruckpegel (gemäß ISO 3744:2010)</p> <p>[16] Messungengenauigkeit</p> <p>[17] Gemessener Schalleistungspegel (gemäß ISO 3744:2010)</p> <p>[18] Garantierter Schalleistungspegel (gemäß 2000/14/EC)</p> <p>[19] Freischneider</p> <p>[20] Zulässige auf die Hand am vorderen Handgriff übertragene Vibrationen (gemäß ISO 3744:2010)</p> <p>[21] Zulässige auf die Hand am hinteren Handgriff übertragene Vibrationen (gemäß ISO 3744:2010)</p> <p>[22] Sonderzubehör</p> <p>[23] Akku</p> <p>[24] Batterieladegerät</p> <p>[25] Batterietasche</p> <p>a) HINWEIS: Der erklärte Gesamtwert der Vibrationen wurde durch eine standardisierte Methode gemessen. Er kann verwendet werden, um einen Vergleich zwischen verschiedenen Werkzeugen anzustellen. Der Gesamtwert der Vibrationen kann auch bei einer Vorabbewertung der Vibrationsbelastung eingesetzt werden.</p> <p>b) WARNUNG: Die Schwingungsemission bei der effektiven Verwendung des Werkzeugs kann sich je nach den Einsatzarten des Werkzeugs vom erklärten Gesamtwert unterscheiden. Deshalb ist es notwendig, während der Arbeit die folgenden Sicherheitsmaßnahmen zu ergreifen, um den Bediener zu schützen: Handschuhe während der Verwendung anziehen, die Einsatzzeiten der Maschine begrenzen und die Zeiten verkürzen, in denen man den Gashebel gedrückt hält.</p>	<p>[1] EL - ΤΕΧΝΙΚΑ ΧΑΡΑΚΤΗΡΙΣΤΙΚΑ</p> <p>[2] ΜΕΓ. τάση τροφοδοσίας</p> <p>[3] ΟΝΟΜΑΣΤΙΚΗ τάση τροφοδοσίας</p> <p>[4] Μέγιστη ταχύτητα περιστροφής εργαλείου (κεφαλή νήματος)</p> <p>[5] Μέγιστη ταχύτητα περιστροφής εργαλείου (δίσκος 4 δοντιών)</p> <p>[6] Πλάτος κοπής (κεφαλή νήματος)</p> <p>[7] Πλάτος κοπής (δίσκος 4 δοντιών)</p> <p>[8] Σύνδεσμος κεφαλής νήματος</p> <p>[9] Διάμετρος νήματος κεφαλής (μέγ.)</p> <p>[10] Κωδικός συστήματος κοπής</p> <p>[11] Κωδικός προστασίας</p> <p>[12] Βάρος</p> <p>[13] Τάση και ρεύμα φόρτισης (Έξοδος USB)</p> <p>[14] Χορτοκοπτικό</p> <p>[15] Στάθμη ηχητικής πίεσης (με βάση το πρότυπο ISO 3744:2010)</p> <p>[16] Αβεβαιότητα μέτρησης</p> <p>[17] Μετρημένη στάθμη ηχητικής ισχύος (με βάση το πρότυπο ISO 3744:2010)</p> <p>[18] Στάθμη εγγυώμενης ηχητικής ισχύος (με βάση το πρότυπο 2000/14/EC)</p> <p>[19] Θαμνοκοπτικό</p> <p>[20] Κραδασμοί στο χέρι στην εμπρός χειρολαβή (με βάση το πρότυπο ISO 3744:2010)</p> <p>[21] Κραδασμοί στο χέρι στην πίσω χειρολαβή (με βάση το πρότυπο ISO 3744:2010)</p> <p>[22] Αιτούμενα παρελκομενα</p> <p>[23] Γκρουπ μπαταρίας</p> <p>[24] Φορτιστής μπαταρίας</p> <p>[25] Ζακίδιο μπαταριών</p> <p>a) ΣΗΜΕΙΩΣΗ: η συνολική δηλωμένη τιμή των κραδασμών έχει μετρηθεί με βάση μια πρότυπη μέθοδο δοκιμής και μπορεί να χρησιμοποιηθεί για τη σύγκριση διάφορων εργαλείων. Η συνολική τιμή των κραδασμών μπορεί επίσης να χρησιμοποιηθεί για μια προκαταρκτική εκτίμηση της έκθεσης.</p> <p>b) ΠΡΟΕΙΔΟΠΟΙΗΣΗ: η εκπομπή κραδασμών κατά την πραγματική χρήση του εργαλείου μπορεί να είναι διαφορετική από τη συνολική δηλωμένη τιμή ανάλογα με τον τρόπο χρήσης του εργαλείου. Επομένως είναι απαραίτητο, κατά την εργασία, να λάβετε τα παρακάτω μέτρα ασφαλείας για την προστασία του χειριστή: φορέστε γάντια κατά τη χρήση, περιορίστε το χρόνο χρήσης του μηχανήματος και μειώστε το χρόνο χρήσης του μοχλού γκαζιού.</p>
---	--	--

<p>[1] EN - TECHNICAL DATA</p> <p>[2] Power supply voltage MAX</p> <p>[3] Power supply voltage NOMINAL</p> <p>[4] Maximum tool rotation speed (cutting line head)</p> <p>[5] Maximum tool rotation speed (3-point blade)</p> <p>[6] Cutting width (cutting line head)</p> <p>[7] Cutting width (4-point blade)</p> <p>[8] Connecting cutting line head</p> <p>[9] Diameter of cutting line (max)</p> <p>[10] Cutting means code</p> <p>[11] Protection code</p> <p>[12] Weight</p> <p>[13] Charging voltage and current (Output USB)</p> <p>[14] Lawn Trimmer</p> <p>[15] Sound pressure level (according to ISO 3744:2010)</p> <p>[16] Uncertainty of measure</p> <p>[17] Measured sound power level (according to ISO 3744:2010)</p> <p>[18] Guaranteed sound power level (according to 2000/14/EC)</p> <p>[19] Brush Cutter</p> <p>[20] Vibrations transmitted to hand on front handle (according to ISO 3744:2010)</p> <p>[21] Vibrations transmitted to hand on rear handle (according to ISO 3744:2010)</p> <p>[22] Accessories available on request</p> <p>[23] Battery pack</p> <p>[24] Battery charger</p> <p>[25] Battery backpack</p> <p>a) NOTE: the declared total vibration value was measured using a normalised test method and can be used to conduct comparisons between one tool and another. The total vibration value can also be used for a preliminary exposure evaluation.</p> <p>b) WARNING: the vibrations emitted during actual use of the tool can differ from the declared total value according to how the tool is used. Whilst working, therefore, it is necessary to adopt the following safety measures designed to protect the operator: wear protective gloves whilst working, use the machine for limited periods at a time and decrease the time during which the throttle control lever is pressed.</p>	<p>[1] ES - DATOS TÉCNICOS</p> <p>[2] Tensión de alimentación MÁX</p> <p>[3] Tensión de alimentación NOMINAL</p> <p>[4] Velocidad máxima de rotación de la herramienta (cabezal porta hilo)</p> <p>[5] Velocidad máxima de rotación de la herramienta (cuchilla de 4 puntas)</p> <p>[6] Ancho de corte (cabezal porta hilo)</p> <p>[7] Ancho de corte (cuchilla de 4 puntas)</p> <p>[8] Enganche cabezal porta hilo</p> <p>[9] Diámetro hilo cabezal (máx)</p> <p>[10] Código dispositivo de corte</p> <p>[11] Código de protección</p> <p>[12] Peso</p> <p>[13] Tensión y corriente de carga (Salida USB)</p> <p>[14] Cortahierbas</p> <p>[15] Nivel de presión sonora (según ISO 3744:2010)</p> <p>[16] Incertidumbre de medida</p> <p>[17] Nivel de potencia sonora medido (según ISO 3744:2010)</p> <p>[18] Nivel de potencia sonora garantizado (según 2000/14/EC)</p> <p>[19] Desbrozadora</p> <p>[20] Vibraciones transmitidas a la mano en la empuñadura anterior (según ISO 3744:2010)</p> <p>[21] Vibraciones transmitidas a la mano en la empuñadura posterior (según ISO 3744:2010)</p> <p>[22] Accesorios bajo pedido</p> <p>[23] Grupo de batería</p> <p>[24] Cargador de batería</p> <p>[25] Mochila portabaterías</p> <p>a) NOTA: el valor total de la vibración se ha medido según un método normalizado de prueba y puede utilizarse para realizar una comparación entre una máquina y otra. El valor total de la vibración también se puede emplear para la valoración preliminar de la exposición.</p> <p>b) ADVERTENCIA: la emisión de vibración en el uso efectivo del aparato puede ser diferente al valor total declarado según los modos en los que se utiliza la herramienta. Por ello, durante la actividad se deben poner en práctica las siguientes medidas de seguridad para el usuario: usar guantes, limitar el tiempo de uso de la máquina, así como el tiempo que se mantiene presionada la palanca de mando del acelerador.</p>	<p>[1] ET - TEHNILISED ANDMED</p> <p>[2] TMAX toitepinge</p> <p>[3] NOMINAALNE toitepinge</p> <p>[4] Lõikeseadme maksimum pöördekiirus (nööripeaga)</p> <p>[5] Lõikeseadme maksimum pöördekiirus (4-otsaluse kettaga)</p> <p>[6] Lõikelaius (nööripeaga)</p> <p>[7] Lõikelaius (4-harulise teraga)</p> <p>[8] Nööripea ühendus</p> <p>[9] Nööripea läbimõõt (maks.)</p> <p>[10] Lõikeseadme kood</p> <p>[11] Kaitse kood</p> <p>[12] Kaal</p> <p>[13] Laadimispinge ja -vool (Väljund USB)</p> <p>[14] Murutrimmer</p> <p>[15] Helirõhu tase (vastavalt ISO 3744:2010)</p> <p>[16] Mõõtemääramatus</p> <p>[17] Helivõimsuse mõõdetav tase (vastavalt ISO 3744:2010)</p> <p>[18] Garanteeritud helivõimsuse tase (vastavalt 2000/14/EC)</p> <p>[19] Võsalõikaja</p> <p>[20] Eesmiselt käepidemelt käele üle kanduv vibratsioon (vastavalt ISO 3744:2010)</p> <p>[21] Tagumiselt käepidemelt käele üle kanduv vibratsioon (vastavalt ISO 3744:2010)</p> <p>[22] Tellimisel lisatarvikud</p> <p>[23] Aku</p> <p>[24] Akulaadija</p> <p>[25] Akukott</p> <p>a) MÄRKUS: deklareeritud koguvibratsiooni tase mõõdeti standardiseeritud testi käigus, mille abil on võimalik võrrelda omavahel erinevate tööriistade vibratsiooni. Deklareeritud koguvibratsiooni võib kasutada ka eeldatava vibratsiooni käes olemise hindamiseks.</p> <p>b) HOIATUS: tegelikud tööriista kasutamisel tekkivad vibratsioonid võivad erineda deklareeritud koguvibratsiooni tasemest sõltuvalt tööriista kasutamise viisist. Seepärast tuleb töö ajal kasutusel võtta ohutusmeetodid, millega töötajat kaitsta: kandke kasutamise ajal kindaid, piirake masina kasutamise aega ja lühendage perioode, mille vältel hoitakse gaasihooba all.</p>
--	---	---

<p>[1] FI - TEKNISET TIEDOT</p> <p>[2] MAKS. syöttöjännite</p> <p>[3] NIMELLINEN syöttöjännite</p> <p>[4] Työkalun maksimipyörimisnopeus (siimapää)</p> <p>[5] Työkalun maksimipyörimisnopeus (4-kärkinen terä)</p> <p>[6] Leikkuuleveys (siimapää)</p> <p>[7] Leikkuuleveys (4-kärkinen terä)</p> <p>[8] Siimapään kiinnitys</p> <p>[9] Siimapään siiman halkaisija (max)</p> <p>[10] Leikkuuväliseen koodi</p> <p>[11] Suojakoodi</p> <p>[12] Paino</p> <p>[13] Syöttöjännite ja -taajuus (Lähtö USB)</p> <p>[14] Ruohonleikkuri</p> <p>[15] Äänenpaineen taso (ISO 3744:2010:n mukaisesti)</p> <p>[16] Mittauksen epävarmuus</p> <p>[17] Mitattu äänitehotaso (ISO 3744:2010:n mukaisesti)</p> <p>[18] Taattu äänitehotaso (2000/14/EC:n mukaisesti)</p> <p>[19] Trimmeri</p> <p>[20] Etukahvaan kohdistuva värinä (ISO 3744:2010:n mukaisesti)</p> <p>[21] Takakahvaan kohdistuva värinä (ISO 3744:2010:n mukaisesti)</p> <p>[22] Tilattavat lisävarusteet</p> <p>[23] Akkuyksikkö</p> <p>[24] Akkulaturi</p> <p>[25] Akkureppu</p> <p>a) HUOMAUTUS: värinän kokonaisarvo on mitattu käyttämällä normalisoitua testimenetelmää ja sitä voidaan käyttää verrattaessa työkaluja keskenään. Värinän kokonaisarvoa voidaan käyttää myös kun tehdään altistumista koskeva esiarviointi.</p> <p>b) VAROITUS: laitteen tuottama värinä työväliseen todellisen käytön aikana saattaa poiketa ilmoitetusta kokonaisarvosta käyttötavasta riippuen. Tämän vuoksi on tarpeen soveltaa seuraavia käyttäjää suojaavia turvatoimenpiteitä: käyttää käsiineitä käytön aikana, rajoittaa laitteen käyttöaikaa ja lyhentää aikoja jolloin kaasuttimen vipua pidetään painettuna.</p>	<p>[1] FR - CARACTÉRISTIQUES TECHNIQUES</p> <p>[2] Tension d'alimentation MAX</p> <p>[3] Tension d'alimentation NOMINALE</p> <p>[4] Vitesse maximum de rotation de l'outil (tête à fil)</p> <p>[5] Vitesse maximum de rotation de l'outil (lame à 4 pointes)</p> <p>[6] Largeur de coupe (tête à fil)</p> <p>[7] Largeur de coupe (lame à 4 pointes)</p> <p>[8] Fixation tête à fil</p> <p>[9] Diamètre fil tête (max.)</p> <p>[10] Code organe de coupe</p> <p>[11] Code protection</p> <p>[12] Poids</p> <p>[13] Tension et courant de charge (Sortie USB)</p> <p>[14] Trimmer</p> <p>[15] Niveau de pression sonore (selon la norme ISO 3744:2010)</p> <p>[16] Incertitude de la mesure</p> <p>[17] Niveau de puissance sonore mesuré (selon la norme ISO 3744:2010)</p> <p>[18] Niveau de puissance sonore garanti (selon la norme 2000/14/EC)</p> <p>[19] Débroussaileuse</p> <p>[20] Vibrations transmises à la main sur la poignée antérieure (selon la norme ISO 3744:2010)</p> <p>[21] Vibrations transmises à la main sur la poignée postérieure (selon la norme ISO 3744:2010)</p> <p>[22] Accessoires sur demande</p> <p>[23] Groupe batterie</p> <p>[24] Chargeur de batterie</p> <p>[25] Sac porte-batteries</p> <p>a) REMARQUE : la valeur totale déclarée des vibrations a été mesurée selon une méthode d'essai normalisée et peut être utilisée pour comparer un outillage avec un autre. La valeur totale des vibrations peut être utilisée aussi pour une évaluation préalable à l'exposition.</p> <p>b) AVERTISSEMENT : l'émission de vibrations lors de l'utilisation effective de l'outillage peut différer de la valeur totale déclarée en fonction des modes d'utilisation de l'outillage. Par conséquent, il est nécessaire, pendant le travail, d'adopter les mesures de sécurité suivantes en vue de protéger l'opérateur : porter des gants durant l'utilisation, limiter les temps d'utilisation de la machine et écourter les temps pendant lesquels le levier de commande de l'accélérateur est enfoncé.</p>	<p>[1] HR - TEHNIČKI PODACI</p> <p>[2] MAKS. napon napajanja</p> <p>[3] NAZIVNI napon napajanja</p> <p>[4] Maksimalna brzina rotacije alata (glava s reznom niti)</p> <p>[5] Maksimalna brzina rotacije alata (trokraki nož)</p> <p>[6] Širina rezanja (glava s reznom niti)</p> <p>[7] Širina rezanja (trokraki nož)</p> <p>[8] Spoj za glavu s reznom niti</p> <p>[9] Promjer niti glave (maks.)</p> <p>[10] Šifra noža</p> <p>[11] Šifra štitnika</p> <p>[12] Težina</p> <p>[13] Napon i struja punjenja (Izlaz USB)</p> <p>[14] Trimer</p> <p>[15] Razina zvučnog tlaka (na osnovu standarda ISO 3744:2010)</p> <p>[16] Mjerna nesigurnost</p> <p>[17] Izmjerena razina zvučne snage (na osnovu standarda ISO 3744:2010)</p> <p>[18] Zajamčena razina zvučne snage (na osnovu standarda 2000/14/EC)</p> <p>[19] Šišač za travu</p> <p>[20] Vibracije koje se prenose na ruku putem prednje ručke (na osnovu standarda ISO 3744:2010)</p> <p>[21] Vibracije koje se prenose na ruku putem stražnje ručke (na osnovu standarda ISO 3744:2010)</p> <p>[22] Dodatni pribor na upit</p> <p>[23] Baterija</p> <p>[24] Razina zvučnog tlaka</p> <p>[25] Torbica za nošenje baterija</p> <p>a) NAPOMENA: izjavljena ukupna vrijednost vibracija izmjerena je pridržavajući se normirane probne metode i može se koristiti za usporedbu jednog alata s drugim. Ukupnu vrijednost vibracija može se koristiti u preliminarnoj procjeni izloženosti.</p> <p>b) UPOZORENJE: emisija vibracija pri stvarnoj uporabi alata može se razlikovati od izjavljene ukupne vrijednosti, ovisno o načinima korištenja alata. Stoga je za vrijeme rada potrebno poduzeti sljedeće sigurnosne mjere namijenjene zaštiti rukovatelja: nositi rukavice tijekom uporabe, ograničiti vrijeme korištenja stroja te skratiti vrijeme držanja pritisnute upravljačke ručice gasa.</p>
--	---	---

<p>[1] HU - MŰSZAKI ADATOK</p> <p>[2] MAX tápfeszültség</p> <p>[3] NÉVLEGES tápfeszültség</p> <p>[4] A szerszám maximális forgási sebessége (huzaltár fej)</p> <p>[5] A szerszám maximális forgási sebessége (4 élű vágólap)</p> <p>[6] Munkaszélesség (huzaltár fej)</p> <p>[7] Munkaszélesség (4 élű vágólap)</p> <p>[8] Huzaltár fej csatlakozó</p> <p>[9] Fej húzal keresztmetszet (max.)</p> <p>[10] Vágóegység kódszáma</p> <p>[11] Védelem kódja</p> <p>[12] Súly</p> <p>[13] Töltő feszültség és áram (kimenet USB)</p> <p>[14] Fűnyíró</p> <p>[15] Hangnyomásszint (ISO 3744:2010 szabvány alapján)</p> <p>[16] Mérési bizonytalanság</p> <p>[17] Mért zajteljesítmény szint (ISO 3744:2010 szabvány alapján)</p> <p>[18] Garantált zajteljesítmény szint (2000/14/EC szabvány alapján)</p> <p>[19] Fűkasza</p> <p>[20] Az elülső markolatnál a kéz felé továbbított rezgések (ISO 3744:2010 szabvány alapján)</p> <p>[21] A hátsó markolatnál a kéz felé továbbított rezgések (ISO 3744:2010 szabvány alapján)</p> <p>[22] Rendelhető tartozékok</p> <p>[23] Akkumulátor egység</p> <p>[24] Akkumulátor-töltő</p> <p>[25] Akkumulátortartó hátizsák</p> <p>a) MEGJEGYZÉS: a rezgés névleges összértékét szabványos teszt módszerrel mértük, ezért alkalmazható más szerszámokkal való összehasonlításra. A rezgés névleges összértéke a kitetszég előzetes értékelésére is alkalmas.</p> <p>b) FIGYELMEZTETÉS: a szerszám valós használata során keletkező rezgés eltérhet a névleges összértéktől a szerszám használati módjának függvényében. Ezért a munka alatt alkalmazni kell a kezelő védelmét szolgáló biztonsági intézkedéseket: viseljen munkakesztyűt a használat során, korlátozza a gép használati idejét és lehetőleg rövid ideig tartsa nyomva a gázkart.</p>	<p>[1] LT - TECHINIAI DUOMENYS</p> <p>[2] MAKS. maitinimo įtampa</p> <p>[3] NOMINALI maitinimo įtampa</p> <p>[4] Maksimalus įrankio (pjovimo valo galvutės) sukimosi greitis</p> <p>[5] Maksimalus įrankio (trišakio peilio) sukimosi greitis</p> <p>[6] Pjovimo plotis (pjovimo valo galvutė)</p> <p>[7] Pjovimo plotis (trišakis peilis)</p> <p>[8] Pjovimo valo galvutės jungtis</p> <p>[9] Valo galvutės skersmuo (maks.)</p> <p>[10] Pjovimo įtaiso kodas</p> <p>[11] Apsaugos kodas</p> <p>[12] Svoris</p> <p>[13] Įkrovos įtampa ir srovė (išėjimas USB)</p> <p>[14] Žoliapjovė</p> <p>[15] Garso slėgio lygis (pagal „ISO 3744:2010“)</p> <p>[16] Matavimo paklaida</p> <p>[17] Išmatuotas garso galios lygis (pagal „ISO 3744:2010“)</p> <p>[18] Garantuotas garso galios lygis (pagal „2000/14/EC“)</p> <p>[19] Krūmapjovė</p> <p>[20] Vibracijos lygis, priekinė rankena (pagal „ISO 3744:2010“)</p> <p>[21] Vibracijos lygis, galinė rankena (pagal „ISO 3744:2010“)</p> <p>[22] Priedai, kuriuos galima užsisakyti</p> <p>[23] Baterijos blokas</p> <p>[24] Baterijos įkroviklis</p> <p>[25] Akumuliatorių laikiklio kuprinė</p> <p>a) PASTABA: bendras deklaruojamas vibracijų lygis buvo išmatuotas laikantis standartizuoto bandymo metodo ir gali būti naudojamas lyginant vieną įrankį su kitu. Bendras vibracijų lygis gali būti naudojamas preliminariam vibracijų įvertinimui.</p> <p>b) ĮSPĖJIMAS: vibracijų skleidimo lygis eksploatuojant įrenginį gali skirtis nuo bendro deklaruojamo vibracijų lygio, priklausomai nuo būdų, kaip bus naudojamas įrankis. Dėl šios priežasties darbo metu yra būtina imtis saugos priemonių, susijusių su operatoriaus apsauga: naudojimo metu mūvėti pirštines, riboti įrenginio darbo trukmę ir trumpinti laiką, kurio metu būna paspausta akceleratoriaus valdymo svirtis.</p>	<p>[1] LV - TEHNISKIE DATI</p> <p>[2] MAKS. barošanas spriegums</p> <p>[3] NOMINĀLAIS barošanas spriegums</p> <p>[4] Maksimālais instrumenta griešanas ātrums (aukļas turēšanas galviņa)</p> <p>[5] Maksimālais instrumenta griešanas ātrums (asmens ar 4 smailēm)</p> <p>[6] Pļaušanas platums (aukļas turēšanas galviņa)</p> <p>[7] Pļaušanas platums (asmens ar 4 smailēm)</p> <p>[8] Aukļas turēšanas galviņas stiprinājums</p> <p>[9] Galviņas aukļas diametrs (maks.)</p> <p>[10] Grieziņierīces kods</p> <p>[11] Aizsarga kods</p> <p>[12] Masa</p> <p>[13] Uzlādes (izejas USB) spriegums un strāva</p> <p>[14] Zāles plāvējs</p> <p>[15] Skaņas spiediena līmenis (Saskaņā ar ISO 3744:2010 prasībām)</p> <p>[16] Mērijumu kļūda</p> <p>[17] Mērītās skaņas jaudas līmenis (Saskaņā ar ISO 3744:2010 prasībām)</p> <p>[18] Garantētais skaņas jaudas līmenis (Saskaņā ar 2000/14/EC prasībām)</p> <p>[19] Krūmgriezis</p> <p>[20] No priekšējā roktura rokami nododamā vibrācija (Saskaņā ar ISO 3744:2010 prasībām)</p> <p>[21] No aizmugurējā roktura rokami nododamā vibrācija (Saskaņā ar ISO 3744:2010 prasībām)</p> <p>[22] Piederumi pēc pieprasījuma</p> <p>[23] Bateriju pakete</p> <p>[24] Akumulatoru lādētājs</p> <p>[25] Akumulatoru pārnēsāšanas mugursoma</p> <p>a) PIEZĪME: kopējā norādītā vibrāciju intensitātes vērtība tika izmērīta, izmantojot standarta pārbaudes metodi, un to var izmantot ierīču savstarpējai salīdzināšanai. Kopējo vibrāciju intensitātes vērtību var izmantot arī sākotnējai ekspozīcijas novērtēšanai.</p> <p>b) BRĪDINĀJUMS: vibrāciju līmenis ierīces faktiskās izmantošanas laikā var atšķirties no kopējās norādītās vērtības, atkarībā no ierīces izmantošanas veida. Tāpēc darba laikā ir svarīgi izmantot šādu operatora aizsardzības līdzekļus: izmantošanas laikā valkājiet cimdus, ierobežojiet mašīnas izmantošanas laiku un sānīsiniet laiku, kuru akceleratora vadības svira atrodas nospieštā stāvoklī.</p>
---	---	---

<p>[1] МК - ТЕХНИЧКИ ПОДАТОЦИ</p> <p>[2] МАКСИМАЛЕН напон</p> <p>[3] НОМИНАЛЕН напон</p> <p>[4] Максимална брзина на ротација на дополнителната опрема (калем со конец)</p> <p>[5] Максимална брзина на ротација на дополнителната опрема (нож со 4 запци)</p> <p>[6] Ширина на косење (калем со конец)</p> <p>[7] Ширина на косење (нож со 4 запци)</p> <p>[8] Прицврстен калем со конец</p> <p>[9] Дијаметар на калемот со конец (макс)</p> <p>[10] Код на уредот за сечење</p> <p>[11] Код на заштитата</p> <p>[12] Тежина</p> <p>[13] Волтажа и енергија за полнење (Излез USB)</p> <p>[14] Тример за трева</p> <p>[15] Ниво на звучен притисок (според ISO 3744:2010)</p> <p>[16] Отстапување од мерењата</p> <p>[17] Измерено ниво на бучава (според ISO 3744:2010)</p> <p>[18] Гарантирано ниво на бучава според 2000/14/EC)</p> <p>[19] Уред за кастрење грмушки</p> <p>[20] Вибрации што се пренесуваат на раце од предната рачка (според ISO 3744:2010)</p> <p>[21] Вибрации што се пренесуваат на раце од задната рачка (според ISO 3744:2010)</p> <p>[22] Додатоци достапни на барање</p> <p>[23] Батерији</p> <p>[24] Полнач за батерија</p> <p>[25] Ранец за батерија</p> <p>a) ЗАБЕЛЕШКА: вкупната посочена вредност за вибрациите е измерена со пробен метод за нормализирање и може да се користи за споредбена вредност на еден уред со друг. Вкупната вредност на вибрациите може да се користи и за прелиминарна проценка на изложеноста.</p> <p>b) ВНИМАНИЕ: емисијата на вибрациите при ефективна употреба може да се разликува од вкупната посочена вредност според начинот на употреба на уредот. Затоа е неопходно во текот на работата да се направат повеќе безбедносни мерења за да се заштити операторот: носете чевли во текот на употребата, ограничете го времето на употреба на машината и скратете го времето кога треба да се притисне рачката за управување со забрзувачот.</p>	<p>[1] NL - TECHNISCHE GEGEVENS</p> <p>[2] Voedingsspanning MAX</p> <p>[3] Voedingsspanning NOMINAL</p> <p>[4] Maximale rotatiesnelheid van het werktuig (draadhouder)</p> <p>[5] Maximale rotatiesnelheid van het werktuig (mes met 4 punten)</p> <p>[6] Snijbreedte (draadhouder)</p> <p>[7] Snijbreedte (mes met 4 punten)</p> <p>[8] Bevestiging draadhouder</p> <p>[9] Diameter draadhouder (max)</p> <p>[10] Code snij-inrichting</p> <p>[11] Code bescherming</p> <p>[12] Gewicht</p> <p>[13] Laadspanning en -stroom (Uitgang USB)</p> <p>[14] Grasmaaier</p> <p>[15] Niveau geluidsdruk (op basis van ISO 3744:2010)</p> <p>[16] Meetonzekerheid</p> <p>[17] Gemeten geluidsvermogeniveau (op basis van ISO 3744:2010)</p> <p>[18] Gegarandeerd geluidsniveau (op basis van 2000/14/EC)</p> <p>[19] Bosmaaier</p> <p>[20] Trillingen overgedragen op de hand op de voorste handgreep (op basis van ISO 3744:2010)</p> <p>[21] Trillingen overgedragen op de hand op de achterste handgreep (op basis van ISO 3744:2010)</p> <p>[22] Optionele accessoires</p> <p>[23] Batterij-eenheid</p> <p>[24] Batterijlader</p> <p>[25] Accuhouder</p> <p>a) OPMERING: de totale verklaarde waarde van de trillingen werd gemeten met een genormaliseerde testmethode en kan gebruikt worden voor een vergelijking tussen twee werktuigen. De totale waarde van de trillingen kan ook gebruikt worden in een voorafgaande evaluatie van de blootstelling.</p> <p>b) WAARSCHUWING: de emissie van trillingen bij het effectief gebruik van het werktuig kan verschillen van de totale verklaarde waarden, al naar gelang de manieren waarop het werktuig gebruikt wordt. Daarom is het noodzakelijk, tijdens het werk, de volgende veiligheidsmaatregelen toe te passen om de bediener te beschermen: handschoenen te gebruiken tijdens het gebruik, het gebruik van de machine te beperken en de de bedieningshendel van de versnellend zo kort mogelijk ingedrukt te houden.</p>	<p>[1] NO - TEKNISKE DATA</p> <p>[2] MAX forsyningsspenning</p> <p>[3] NOMINAL forsyningsspenning</p> <p>[4] Maksimal omdreiningshastighet for verktøyet (trådspolen)</p> <p>[5] Maksimal omdreiningshastighet for verktøyet (knivblad med 4 spisser)</p> <p>[6] Klippebredde (trådspole)</p> <p>[7] Klippebredde (knivblad med 4 spisser)</p> <p>[8] Feste for trådspole</p> <p>[9] Diameter for trådspolens tråd (maks)</p> <p>[10] Artikkelnummer for klippenretning</p> <p>[11] Artikkelnummer for vern</p> <p>[12] Vekt</p> <p>[13] Ladespenning og strøm (Utgang USB)</p> <p>[14] Gresstrimmer</p> <p>[15] Lydtrykknivå (iht. ISO 3744:2010)</p> <p>[16] Måleusikkerhet</p> <p>[17] Målt lydeffektivnivå (iht. ISO 3744:2010)</p> <p>[18] Garantert lydeffektivnivå (iht. 2000/14/EC)</p> <p>[19] Ryddesag</p> <p>[20] Vibrasjoner overført til hånden på det fremre håndtaket (iht. ISO 3744:2010)</p> <p>[21] Vibrasjoner overført til hånden på det bakre håndtaket (iht. ISO 3744:2010)</p> <p>[22] Tilleggsutstyr på forespørsel</p> <p>[23] Batterienhet</p> <p>[24] Batterilader</p> <p>[25] Batteriryggsekk</p> <p>a) MERK: Oppgitt totalverdi for vibrasjonene har blitt målt ved å bruke en normal prøvemetode og kan brukes for å sammenligne et redskap med et annet. Den totale vibrasjonsverdien kan også brukes i en foreløpig eksponeringsvurdering.</p> <p>b) ADVARSEL: emisjon av vibrasjoner ved effektiv bruk av redskapet kan avvike fra oppgitt totalverdi i henhold til måten redskapet brukes på. Derfor er det nødvendig, under arbeidet, å ta i bruk følgende sikkerhetstiltak for å beskytte operatøren: iføre seg hansker ved bruk, begrense maskinens brukstid og korte ned på tiden som man holder inne akselerator kommandospaken.</p>
--	--	--

<p>[1] PL - DANE TECHNICZNE</p> <p>[2] Napięcie zasilania MAKS</p> <p>[3] Napięcie zasilania ZNAMIONOWE</p> <p>[4] Maksymalna prędkość obrotowa urządzenia (głowica żyłkowa)</p> <p>[5] Maksymalna prędkość obrotowa urządzenia (ostrze 4 - zębne)</p> <p>[6] Szerokość cięcia (głowica żyłkowa)</p> <p>[7] Szerokość cięcia (ostrze 4 - zębne)</p> <p>[8] Montaż głowicy żyłkowej</p> <p>[9] Średnica głowicy żyłkowej (maks)</p> <p>[10] Kod agregatu tnącego</p> <p>[11] Kod zabezpieczenia</p> <p>[12] Ciężar</p> <p>[13] Napięcie i prąd ładowania (Wyjście USB)</p> <p>[14] Kosiarzka</p> <p>[15] Poziom ciśnienia akustycznego (zgodnie z ISO 3744:2010)</p> <p>[16] Błąd pomiaru</p> <p>[17] Mierzony poziom mocy akustycznej (zgodnie z ISO 3744:2010)</p> <p>[18] Gwarantowany poziom mocy akustycznej (zgodnie z 2000/14/EC)</p> <p>[19] Podkaszarka</p> <p>[20] Wibracje przekazywane na rękę poprzez uchwyt przedni (zgodnie z ISO 3744:2010)</p> <p>[21] Wibracje przekazywane na rękę poprzez uchwyt tylny (zgodnie z ISO 3744:2010)</p> <p>[22] Akcesoria dostępne na zamówienie</p> <p>[23] Zespół akumulatora</p> <p>[24] Ładowarka akumulatora</p> <p>[25] Plecakowy uchwyt na akumulator</p> <p>a) UWAGA: Całkowita wskazana wartość drgań została zmierzona zgodnie ze znormalizowaną metodą badania i może być wykorzystana w celu dokonania porównania między dwoma urządzeniami. Całkowita wartość drgań może być również stosowana do wstępnej oceny zagrożenia.</p> <p>b) UWAGA: emisja drgań w praktycznym zastosowaniu niniejszego narzędzia może się różnić od deklarowanej wartości łącznej, w zależności od sposobu użytkowania urządzenia. Dlatego, w celu zapewnienia bezpieczeństwa użytkownika, konieczne jest podczas pracy z urządzeniem podjęcie następujących środków bezpieczeństwa: noszenie rękawic podczas korzystania z urządzenia, ograniczenie czasu użytkowania urządzenia i skrócenie czasu trzymania wciśniętej dźwigni obrotów silnika.</p>	<p>[1] PT - DADOS TÉCNICOS</p> <p>[2] Tensão de alimentação MÁX</p> <p>[3] Tensão de alimentação NOMINAL</p> <p>[4] Velocidade máxima de rotação da ferramenta (cabeça porta-fio)</p> <p>[5] Velocidade máxima de rotação da ferramenta (lâmina de 4 pontas)</p> <p>[6] Largura de corte (cabeça porta-fio)</p> <p>[7] Largura de corte (lâmina de 4 pontas)</p> <p>[8] Engate cabeça porta-fio</p> <p>[9] Diâmetro fio da cabeça (máx)</p> <p>[10] Código dispositivo de corte</p> <p>[11] Código de proteção</p> <p>[12] Peso</p> <p>[13] Tensão e corrente de carga (Saída USB)</p> <p>[14] Corta-erva</p> <p>[15] Nível de pressão sonora (com base na ISO 3744:2010)</p> <p>[16] Incerteza de medição</p> <p>[17] Nível medido de potência sonora (com base na ISO 3744:2010)</p> <p>[18] Nível garantido de potência sonora (com base na 2000/14/EC)</p> <p>[19] Aparadora</p> <p>[20] Vibrações transmitidas na mão sobre a pega dianteira (com base na ISO 3744:2010)</p> <p>[21] Vibrações transmitidas na mão sobre a pega traseira (com base na ISO 3744:2010)</p> <p>[22] Acessórios a pedido</p> <p>[23] Grupo bateria</p> <p>[24] Carregador de bateria</p> <p>[25] Mochila porta-baterias</p> <p>a) NOTA: o valor total declarado das vibrações foi mensurado de acordo com um método normalizado de ensaio e pode ser utilizado para comparar uma ferramenta com a outra. O valor total das vibrações também pode ser utilizado para uma avaliação preliminar da exposição.</p> <p>b) ADVERTÊNCIA: a emissão de vibrações no uso efetivo da ferramenta pode ser diversa do valor total declarado de acordo com os modos com os quais a ferramenta é utilizada. Portanto, durante o trabalho, é necessário adotar as seguintes medidas de segurança para proteger o operador: usar luvas durante o uso, limitar o tempo de utilização da máquina e encurtar o tempo durante o qual a alavanca de comando é mantida pressionada.</p>	<p>[1] RO - DATE TEHNICE</p> <p>[2] Tensiune de alimentare MAX</p> <p>[3] Tensiune de alimentare NOMINALĂ</p> <p>[4] Viteză maximă de rotație a sculei (unitate de suport fir)</p> <p>[5] Viteză maximă de rotație a sculei (lamă cu 4 dinți)</p> <p>[6] Lățime de tăiere (cap de suport fir)</p> <p>[7] Lățime de tăiere (lamă cu 4 dinți)</p> <p>[8] Punct de prindere a unității de suport fir</p> <p>[9] Diametru fir unitate (max)</p> <p>[10] Codul dispozitivului de tăiere</p> <p>[11] Codul protecției</p> <p>[12] Greutate</p> <p>[13] Tensiune și curent de încărcare (leșire USB)</p> <p>[14] Cositoare iarbă</p> <p>[15] Nivel de presiune sonoră (în conformitate cu ISO 3744:2010)</p> <p>[16] Nesigurantă în măsurare</p> <p>[17] Nivel de putere sonoră măsurat (în conformitate cu ISO 3744:2010)</p> <p>[18] Nivel de putere sonoră garantat (în conformitate cu 2000/14/EC)</p> <p>[19] Coasă electrică</p> <p>[20] Vibrații percepute de mâna operatorului, pe mânerul anterior (în conformitate cu ISO 3744:2010)</p> <p>[21] Vibrații percepute de mâna operatorului, pe mânerul posterior (în conformitate cu ISO 3744:2010)</p> <p>[22] Accesorii la cerere</p> <p>[23] Grupul acumulator</p> <p>[24] Alimentator pentru baterie</p> <p>[25] Rucsac pentru baterii</p> <p>a) OBSERVAȚIE: valoarea totală declarată a vibrațiilor a fost măsurată ținându-se cont de o metodă de probă normalizată și poate fi utilizată pentru a compara instrumentele între ele. Valoarea totală a vibrațiilor poate fi utilizată și pentru o evaluare preliminară a expunerii.</p> <p>b) AVERTISMENT: emisia de vibrații în utilizarea efectivă a instrumentului poate fi diferită față de valoarea totală declarată, în funcție de modulele în care se utilizează instrumentul. Din acest motiv este nevoie ca, în timpul sesiunii de lucru, să se adopte următoarele măsuri de siguranță menite să protejeze operatorul: purtarea mănușilor în timpul utilizării, limitarea duratei de utilizarea a mașinii și scurtarea duratei în care se ține apăsată maneta de comandă a acceleratorului.</p>
--	---	---

<p>[1] RU - ТЕХНИЧЕСКИЕ ХАРАКТЕРИСТИКИ</p> <p>[2] МАКС. напряжение питания</p> <p>[3] НОМИНАЛЬНОЕ напряжение питания</p> <p>[4] Максимальная скорость вращения инструмента (триммерная головка)</p> <p>[5] Максимальная скорость вращения инструмента (нож с 4 лопастями)</p> <p>[6] Ширина скашивания (триммерная головка)</p> <p>[7] Ширина скашивания (нож с 4 лопастями)</p> <p>[8] Крепление триммерной головки</p> <p>[9] Диаметр корда (макс.)</p> <p>[10] Код режущего приспособления</p> <p>[11] Код защиты</p> <p>[12] Вес</p> <p>[13] Напряжение и зарядный ток (Выход USB)</p> <p>[14] газонокосилка</p> <p>[15] Уровень звукового давления (согласно ISO 3744:2010)</p> <p>[16] Погрешность измерения</p> <p>[17] Уровень измеренной звуковой мощности (согласно ISO 3744:2010)</p> <p>[18] Гарантируемый уровень звуковой мощности (согласно 2000/14/EC)</p> <p>[19] Уровень вибрации</p> <p>[20] Вибрация, сообщаемая руке на передней рукоятке (согласно ISO 3744:2010)</p> <p>[21] Вибрация, сообщаемая руке на задней рукоятке (согласно ISO 3744:2010)</p> <p>[22] Принадлежности – навесные орудия по заказу</p> <p>[23] Аккумулятор</p> <p>[24] Зарядное устройство</p> <p>[25] Ранцевый держатель для батарей</p> <p>a) ПРИМЕЧАНИЕ: общий заявленный уровень вибрации был измерен с использованием нормализованного метода испытаний, и его можно использовать для сравнения различных инструментов между собой. Общий уровень вибрации можно также использовать для предварительной оценки подверженности воздействию вибрации.</p> <p>b) ПРЕДУПРЕЖДЕНИЕ: уровень вибрации во время фактической эксплуатации инструмента может отличаться от общего заявленного значения и зависит от режимов эксплуатации инструмента. Поэтому во время работы необходимо принимать следующие меры безопасности для защиты оператора: работать в перчатках, ограничивать время использования машины и сокращать время, в течение которого рычаг управления дросселем остается нажатым.</p>	<p>[1] SK - TECHNICKÉ PARAMETRE</p> <p>[2] MAX. napájacie napätie</p> <p>[3] NOMINÁLNE napájacie napätie</p> <p>[4] Maximálna rýchlosť otáčania nástroja (strunová hlava)</p> <p>[5] Maximálna rýchlosť otáčania nástroja (trojzubec)</p> <p>[6] Záber (strunová hlava)</p> <p>[7] Záber (trojzubec)</p> <p>[8] Úchyt strunovej hlavy</p> <p>[9] Priemer struny (max.)</p> <p>[10] Kód kosiaceho zariadenia</p> <p>[11] Kód ochranného krytu</p> <p>[12] Hmotnosť</p> <p>[13] Nabíjacie napätie a prúd (výstup USB)</p> <p>[14] Kosačka</p> <p>[15] Úroveň akustického tlaku (na základe ISO 3744:2010)</p> <p>[16] Nepresnosť merania</p> <p>[17] Hladina nameraného akustického výkonu (na základe ISO 3744:2010)</p> <p>[18] Zaručená úroveň akustického výkonu (na základe 2000/14/EC)</p> <p>[19] Krovinorez</p> <p>[20] Vibrácie prenášané na ruku na prednej rukoväti (na základe ISO 3744:2010)</p> <p>[21] Vibrácie prenášané na ruku na zadnej rukoväti (na základe ISO 3744:2010)</p> <p>[22] Prídavné zariadenia na požiadanie</p> <p>[23] Akumulátorová jednotka</p> <p>[24] Nabíjačka akumulátora</p> <p>[25] Batoh na akumulátory</p> <p>a) POZNÁMKA: vyhlásená celková hodnota vibrácií bola nameraná s použitím normalizovanej skúšobnej metódy a je možné ju použiť na porovnanie jednotlivých nástrojov. Celková hodnota vibrácií môže byť použitá aj pri prípravnom vyhodnocovaní vibrácií.</p> <p>b) VAROVANIE: emisia vibrácií pri skutočnom použití nástroja môže byť odlišná od vyhlásenej celkovej hodnoty v závislosti na režimoch, v ktorých sa daný nástroj používa. Preto je potrebné počas práce prijať nižšie uvedené bezpečnostné opatrenia, ktoré majú za cieľ ochrániť operátora: počas bežného použitia majte nasadené rukavice, obmedzte dobu použitia stroja a skráťte doby, počas ktorých je zatlačená ovládacia páka plynu.</p>	<p>[1] SL - TEHNIČNI PODATKI</p> <p>[2] Največja napetost električnega napajanja</p> <p>[3] Nazivna napetost električnega napajanja</p> <p>[4] Največja hitrost rotacije orodja (glava z nitjo)</p> <p>[5] Največja hitrost rotacije orodja (rezilo s tremi konicami)</p> <p>[6] Širina košnje (glava z nitjo)</p> <p>[7] Širina košnje (rezilo s tremi konicami)</p> <p>[8] Priključek za glavo z nitjo</p> <p>[9] Premer niti (max)</p> <p>[10] Šifra rezalne naprave</p> <p>[11] Šifra zaščite</p> <p>[12] Teža</p> <p>[13] Napetost in tok polnjenja (izhod USB)</p> <p>[14] Kosilnica</p> <p>[15] Raven zvočnega pritiska (glede na ISO 3744:2010)</p> <p>[16] Merilna negotovost</p> <p>[17] Raven izmerjene zvočne moči (glede na ISO 3744:2010)</p> <p>[18] Raven zagotovljene zvočne moči (glede na 2000/14/EC)</p> <p>[19] Obrezovalnik</p> <p>[20] Vibracije, ki se prenašajo na roko na sprednjem ročaju (glede na ISO 3744:2010)</p> <p>[21] Vibracije, ki se prenašajo na roko na zadnjem ročaju (glede na ISO 3744:2010)</p> <p>[22] Dodatni priključki na zahtevo</p> <p>[23] Enota baterije</p> <p>[24] Polnilnik baterije</p> <p>[25] Nahrtnik za baterije</p> <p>a) OPOMBA: Deklarirana skupna vrednost vibracij je bila izmerjena v skladu z normirano metodo preizkušanja; mogoče jo je uporabiti za primerjavo med različnimi orodji. Skupna vrednost vibracij se lahko uporabi tudi za predhodno oceno izpostavitve.</p> <p>b) OPOZORILO: Med dejansko uporabo orodja se oddajane vibracije lahko razlikujejo od deklarirane skupne vrednosti, kar je odvisno od načina uporabe orodja. Zato je treba med delom udeležati naslednje varnostne ukrepe za zaščito upravljavca: med delom nosite rokavice, omejite čas uporabe stroja in skrajšajte intervale, med katerimi pritisnete na komandni vzvod pospeševalnika.</p>
---	---	---

<p>[1] SR - TEHNIČKI PODACI</p> <p>[2] Napon napajanja MAKŠ</p> <p>[3] Napon napajanja NOMINALN</p> <p>[4] Maksimalna brzina okretanja alatke (glava s reznom niti)</p> <p>[5] Maksimalna brzina okretanja alatke (trokrako sečivo)</p> <p>[6] Širina rezanja (glava s reznom niti)</p> <p>[7] Širina rezanja (trokrako sečivo)</p> <p>[8] Priključak za glavu s reznom niti</p> <p>[9] Prečnik niti glave (maks.)</p> <p>[10] Šifra rezne glave</p> <p>[11] Šifra štitnika</p> <p>[12] Težina</p> <p>[13] Napon i struja punjenja (izlaz USB)</p> <p>[14] Sekač trave</p> <p>[15] Nivo zvučnog pritiska (na osnovu standarda ISO 3744:2010)</p> <p>[16] Merna nesigurnost</p> <p>[17] Izmeren nivo zvučne snage (na osnovu standarda ISO 3744:2010)</p> <p>[18] Garantovan nivo zvučne snage (na osnovu standarda 2000/14/EC)</p> <p>[19] Trimer</p> <p>[20] Vibracije koje se prenose na ruku na prednjoj dršci (na osnovu standarda ISO 3744:2010)</p> <p>[21] Vibracije koje se prenose na ruku na levjoj dršci (na osnovu standarda ISO 3744:2010)</p> <p>[22] Dodatna oprema na zahtev</p> <p>[23] Akumulatorska baterija</p> <p>[24] Punjač baterije</p> <p>[25] Ranac za baterije</p> <p>a) NAPOMENA: ukupna prijavljena vrednost vibracija izmerena je prema normalizovanoj metodi ispitivanja i može se koristiti za poređenje dve alatke. Ukupna vrednost vibracija može se koristiti i prilikom uvodne procene izloženosti.</p> <p>b) UPOZORENJE: emisija vibracija prilikom efektivne upotrebe alatke može se razlikovati od ukupne prijavljene vrednosti u zavisnosti od načina na koji se koristi alatka. Stoga je potrebno, za vreme rada, primeniti sledeće sigurnosne mere u cilju zaštite radnika: nositi rukavice za vreme upotrebe, smanjiti vreme korišćenja mašine i skratiti vreme pritiskanja poluge komande gasa.</p>	<p>[1] SV - TEKNISKA SPECIFIKATIONER</p> <p>[2] Matningsspänning MAX</p> <p>[3] Matningsspänning NOMINAL</p> <p>[4] Verktygets maximala rotationshastighet (trimmerhuvud)</p> <p>[5] Verktygets maximala rotationshastighet (4-tandat blad)</p> <p>[6] Klippbredd (trimmerhuvud)</p> <p>[7] Klippbredd (4-tandat blad)</p> <p>[8] Fäste för trimmerhuvud</p> <p>[9] Trådens diameter (max)</p> <p>[10] Skårenhetens kod</p> <p>[11] Skyddskod</p> <p>[12] Vikt</p> <p>[13] Spänning och laddningsström (Utgång USB)</p> <p>[14] Grästrimmer</p> <p>[15] Ljudtrycksnivå (enligt ISO 3744:2010)</p> <p>[16] Tivvel med mått</p> <p>[17] Uppmått ljudeffektiv (enligt ISO 3744:2010)</p> <p>[18] Garanterad ljudeffektiv (enligt 2000/14/EC)</p> <p>[19] Trimmer</p> <p>[20] Vibrationer på handen på det främre handtaget (enligt ISO 3744:2010)</p> <p>[21] Vibrationer på handen på det bakre handtaget (enligt ISO 3744:2010)</p> <p>[22] Fyllvalstillbehör</p> <p>[23] Batterigrupp</p> <p>[24] Batteriladdare</p> <p>[25] Batteriväska</p> <p>a) ANMÄRKNING: det totala angivna vibrationsvärdet har mätts i enlighet med en standardiserad testmetod och kan användas för en jämförelse mellan olika verktyg. Det totala vibrationsvärdet kan användas även vid en preliminär exponeringsbedömning.</p> <p>b) WARNING: vibrationsemissioner under användningen av verktyget kan skilja sig från det totala värdet som anges beroende på hur verktyget används. Därför är det nödvändigt, under arbetet, att tillämpa de följande säkerhetsåtgärderna som avses för att skydda föraren: bär handskar under användningen, begränsa användningstiden och tiderna som gasreglagets spak hålls nedtryckt.</p>	<p>[1] TR - TEKNİK VERİLER</p> <p>[2] MAKŠ. besleme gerilimi</p> <p>[3] NOMİNAL besleme gerilimi</p> <p>[4] Aletin maksimum rotasyon hızı (misinali kesme kafası)</p> <p>[5] Aletin maksimum rotasyon hızı (4 uçlu bıçak)</p> <p>[6] Kesim genişliđi (misinali kesme kafası)</p> <p>[7] Kesim genişliđi (4 uçlu bıçak)</p> <p>[8] Misinali kesme kafası bağlantısı</p> <p>[9] Kesme kafası çapı (maks)</p> <p>[10] Kesim düzeni kodu</p> <p>[11] Koruma kodu</p> <p>[12] Ağırılık</p> <p>[13] Şarj gerilimi ve akımı (Çıkış USB)</p> <p>[14] Çim biçme makinesi</p> <p>[15] Ses basınç seviyesi (ISO 3744:2010'e dayalı)</p> <p>[16] Ölçü belirsizliđi</p> <p>[17] Ölçülen ses güç seviyesi (ISO 3744:2010'e dayalı)</p> <p>[18] Garanti edilen ses güç seviyesi (2000/14/EC'e dayalı)</p> <p>[19] Çalı budama makinesi[</p> <p>[20] Ön kabza üzerindeki ele aktarılan titreşim (ISO 3744:2010'e dayalı)</p> <p>[21] Arka kabza üzerindeki ele aktarılan titreşim (ISO 3744:2010'e dayalı)</p> <p>[22] Talep üzerine aksesuarlar</p> <p>[23] Batarya grubu</p> <p>[24] Batarya şarjörü</p> <p>[25] Batarya sırt çantası</p> <p>a) NOT: beyan edilen toplam titreşim değeri, normalize edilmiş test yöntemine uygun şekilde ölçülmüştür ve bir takım ile diđeri arasında karşılaştırma yapmak amacıyla kullanılabilir. Toplam titreşim değeri aynı zamanda maruz kalma durumuna dair ön değerlendirme yaparken de kullanılabilir.</p> <p>b) UYARI: takımın etkili kullanımını sırasında yayılan titreşim, takımın kullanılma şekline bađlı olarak beyan edilen toplam değerden farklı olabilir. Bu nedenle, çalışma yapılırken operatörü korumaya yönelik aşıđıdaki güvenlik tedbirleri alınmalıdır: kullanım sırasında eldiven takın, makinenin kullandığı süreleri sınırlandırın ve gaz kumanda levyesinin basılı tutulduđu süreleri kısaltın.</p>
--	---	--

**INDEX**

1. GENERAL INFORMATION	1
2. SAFETY REGULATIONS	2
3. ABOUT THE MACHINE	8
3.1 Machine description and intended use	8
3.2 Safety signs	9
3.3 Product identification label	9
3.4 Main components	10
4. ASSEMBLY	10
4.1 Assembly components	10
4.2 Fitting the handle bar	10
4.3 Fitting/removing cutting means and specific guards	11
4.4 Fitting the battery backpack	12
5. CONTROLS	12
5.1 Throttle control lever	12
5.2 Throttle safety button	12
6. USING THE MACHINE	12
6.1 Preliminary operations	12
6.2 Safety checks	13
6.3 Start-up	13
6.4 Operation	14
6.5 Operating suggestions	15
6.6 Stop	15
6.7 After use	15
7. ROUTINE MAINTENANCE	15
7.1 General Information	15
7.2 Battery	16
7.3 Cleaning the machine and the engine	16
7.4 Nuts and bolts	16
8. OCCASIONAL MAINTENANCE	17
8.1 Cutting means maintenance	17
8.2 Sharpening the wire cutting blade	17
9. STORAGE	17
9.1 Storing	17
9.2 Storing the battery	18
10. HANDLING AND TRANSPORT	18
11. ASSISTANCE AND REPAIRS	18
12. WARRANTY COVERAGE	18
13. MAINTENANCE TABLE	19
14. TROUBLESHOOTING	19
15. ACCESSORIES ON REQUEST	21

1. GENERAL INFORMATION**1.1 HOW TO READ THIS MANUAL**

Some of the paragraphs in this manual contain particularly important information in terms of safety and operation, and are highlighted differently, according to the following criteria:

 DANGER

Failure to observe the warning can lead to possible personal and/or third party injury and/or damage.

 ATTENTION

Provides details or further information on what has been previously indicated and aims to prevent damage to the machine or cause other damage.

NOTE

Provides additional information unrelated to dangerous or potentially damaging situations.

.....
 • The paragraphs highlighted in a dotted grey
 • square indicate optional characteristics
 • not available on all models documented
 • in this manual. Check if the characteristics
 • are available on this model.

Whenever reference is made to a position on the machine "front", "back", "left" or "right" hand side, this refers to the operator's working position.

1.2 REFERENCES**1.2.1 Figures**

The figures in these instructions for use are numbered 1, 2, 3, etc. Components shown in the figures are marked A, B, C, etc. Reference to component C in figure 2 is indicated with the wording: "See fig. 2.C" or simply "(Fig. 2.C)". The figures are provided by way of example. The actual pieces can differ from those illustrated in this document.

1.2.2 Titles

The manual is arranged in chapters and paragraphs. The title of paragraph "2.1 Training" is a sub-title of "2. Safety regulations". References to titles or paragraphs are marked with the abbreviation chap. or para. and the relevant number. Example: "chap. 2" or "para. 2.1."

2. SAFETY REGULATIONS

2.1 GENERAL SAFETY WARNINGS

DANGER

Read all safety warnings, instructions, illustrations and specifications. provided with this power tool. *Failure to follow all instructions listed below may result in electric shock, fire and/or serious injury.*

Save all warnings and instructions for future reference.

The term "power tool" in the warnings refers to your mains-operated (corded) power tool or battery-operated (cordless) power tool.

1) Work area safety

- a) **Keep work area clean and well lit.**
Cluttered or dark areas invite accidents.
- b) **Do not operate power tools in explosive atmospheres, such as in the presence of flammable liquids, gases or dust.** *Power tools create sparks which may ignite the dust or fumes.*
- c) **Keep children and bystanders well away while using power tools.**
Distractions can cause you to lose control.

2) Electrical safety

- a) **Avoid body contact with earthed or grounded surfaces, such as pipes, radiators, cookers and refrigerators.**
There is an increased risk of electric shock if your body is earthed or grounded.
- b) **Do not expose power tools to rain or wet environments.** *Water entering a power tool will increase the risk of electrical shock.*

3) Personal safety

- a) **Stay alert, check what you are doing and use common sense when using a power tool. Do not use the power tool when you are tired or under the influence of drugs, alcohol or**

medicines. A moment of inattention while operating a power tool may result in serious personal injury.

- b) **Use personal protective equipment. Always wear eye protection.** *Protective equipment such as a dust mask, non-skid safety shoes, hard hat or hearing protection used for appropriate conditions will reduce personal injuries.*
 - c) **Prevent unintentional starting. Make sure the appliance is turned off before inserting the battery pack, picking up or carrying the power tool.** *Carrying power tools with your finger on the switch or mounting the battery with the switch in "ON" position invites accidents.*
 - d) **Remove any adjusting key or wrench before turning the power tool on.** *A wrench or a key left attached to a rotating part of the machine may result in personal injury.*
 - e) **Do not overreach. Keep proper footing and balance at all times.** *This enables better control of the power tool in unexpected situations.*
 - f) **Dress properly. Do not wear loose clothing or jewellery. Keep your hair and clothing away from moving parts.** *Loose clothes, jewellery or long hair can be caught in moving parts.*
 - g) **If devices are provided for the connection of dust extraction and collection facilities, ensure these are connected and properly used.** *Use of dust collection can reduce dust-related hazards.*
 - h) **Do not let familiarity gained from frequent use of tools allow you to become complacent and ignore tool safety principles.** *A careless action can cause severe injury within a fraction of a second.*
- #### 4) Power tool use and care
- a) **Do not force the power tool. Use the correct power tool for your application.** *The correct power tool will do the job better and safer at the speed for which it was designed.*
 - b) **Do not use the power tool if the switch does not turn it on and off.** *Any power tool that cannot be controlled with the switch is dangerous and must be repaired.*
 - c) **Remove the battery pack from the machine before making any adjustments, changing accessories or storing the power tool.** *Such preventive safety measures reduce the risk of starting the power tool accidentally.*

- d) **Store idle power tools out of the reach of children and do not allow persons unfamiliar with the power tool or these instructions to operate the machine.** *Power tools are dangerous in the hands of untrained users.*
- e) **Maintain power tools and accessories. Check for misalignment or binding of moving parts, breakage of parts and any other condition that may affect power tool operation. In case of damage, the power tool must be repaired before it can be used.** *Many accidents are caused by poor maintenance.*
- f) **Keep cutting tools sharp and clean.** *Properly maintained cutting tools with sharp cutting edges are less likely to bind and are easier to control.*
- g) **Use the power tool and its accessories in accordance with these instructions, taking into account the working conditions and the task to be performed.** *Using the power tool for operations other than those intended could result in a hazardous situation.*
- h) **Keep handles and grasping surfaces dry, clean and free from oil and grease.** *Slippery handles and grasping surfaces do not allow for safe handling and control of the tool in unexpected situations.*

5) Battery tool use and care

- a) **Recharge only with the charger specified by the manufacturer.** *A charger that is suitable for one type of battery pack may create a risk of fire, electric shock, overheating or corrosive liquid to leak from the battery. when used with another battery pack.*
- b) **Use power tools exclusively with specifically designated battery packs.** *Use of any other battery packs may create a risk of injury and fire.*
- c) **When the battery pack is not in use, keep it away from other metal objects such as paper clips, coins, keys, nails, screws or other small metal objects that may create a connection from one terminal to another.** *Shorting the battery terminals together can cause burns or a fire.*
- d) **Under abusive conditions, liquid may be ejected from the battery: avoid contact. If contact accidentally occurs, flush with water. If the liquid contacts eyes, seek medical help**

immediately. *Fluid ejected from the battery may cause irritation and burns.*

- e) **Do not use a battery pack or tool that is damaged or modified.** *Damaged or modified batteries may exhibit unpredictable behaviour resulting in fire, explosion or risk of injury.*
- f) **Do not expose a battery pack or tool to fire or excessive temperature.** *Exposure to fire or temperature above 130 °C may cause explosion.*
- g) **Charge only at room temperature, between 0° + 45°C. Do not charge the battery pack or tool outside the specified temperature range.** *Charging improperly or at temperatures outside the specified range may damage the battery and increase the risk of fire.*
- 6) **Service**
- a) **Have your power tool serviced by a qualified repair person using only identical replacement parts.** *This will ensure that the safety of the power tool is maintained.*
- b) **Never service damaged battery packs.** *Service of battery packs should only be performed by the manufacturer or authorized service providers.*

2.2 TRAINING

DANGER

Become acquainted with the controls and the proper use of the machine. Learn how to stop the machine quickly. Failure to follow the warnings and instructions may result in fire and/or serious injury.

- **Never allow the machine to be used by children or individuals who are not familiar with the instructions.** *Local laws may establish a minimum age for users.*
- **Never use the machine if the user is tired or unwell, or has taken medication, drugs, alcohol or substances that impair reflexes and concentration.**

- Remember that the operator or user is responsible for accidents and unexpected events that can occur to other people or property. It is the user's responsibility to assess the potential risk of the area where work is to be carried out and to take all the necessary precautions to ensure his own safety and that of others, particularly on slopes or rough, slippery and unstable ground.
- If the machine is sold or lent to others, make sure that the operator looks over the user instructions contained in this manual.

2.3 PRELIMINARY OPERATIONS

Personal Protective Equipment (PPE)

- Always wear slim-fitting protective clothes with slash-proof protection, anti-vibration gloves, helmet, protective goggles, half-mask respirator, protective earplugs, cut resistant safety boots with non-slip soles.
- Use of hearing protections can reduce the ability to hear any warnings (shouting or alarms). Be careful of what occurs around you in the work area.
- Never wear scarves, shirts, necklaces, bracelets, loose flowing clothing, laces or ties or any hanging or flapping accessory that could catch in the machine or in any objects or materials in the work area.
- Tie your hair back if it is long.

Work / Machine Area

- Thoroughly inspect the entire work area and remove

anything that could be thrown by the machine or damage the cutting means/rotating units (stones, branches, iron wire, bones, etc.).

2.4 DURING OPERATION

Work Area

- Do not use the machine in environments that pose the risk of explosion, in the presence of flammable liquids, gases or powders. Power tools create sparks which may ignite the dust or fumes.
- Work only in daylight or with good artificial light in good visibility conditions.
- Keep people, children and animals away from the work area. Children must be supervised by another adult.
- Check that there is nobody within 15 metres of the machine's range of operation or within 30 metres for heavier cutting.
- Avoid working with wet grass, in the rain and when there is a risk of a thunderstorm, especially lightening.
- Where possible, avoid working on wet, slippery ground or on uneven or steep ground that does not guarantee stability for the operator.
- Do not expose the machine to rain or wet environments. Water entering a power tool will increase the risk of electric shock.
- Pay careful attention to uneven ground (hills, dips), slopes, hidden hazards and obstacles that could limit visibility.
- Be very careful near ravines, ditches or embankments.

- Always work across the face of the slope and never up and down it, being very careful when changing direction, making sure the cutting means is always downstream.
- Look out for traffic when using the machine near the road.

Conduct

- When working, the machine must always be firmly held in both hands, keeping the power unit on the right of the body and the cutting group below the line of the belt. Do not excessively extend arms.
- Avoid body contact with earthed or grounded surfaces, such as pipes, radiators, cookers and refrigerators. There is an increased risk of electric shock if your body is earthed or grounded.
- Always use caution and take on a firm and well-balanced position.
- Never run, always walk.
- During operation, always keep the machine connected to the battery backpack.
- Always keep hands and feet away from the cutting means, when starting and when using the machine.
- Attention: the cutting means will continue to rotate for a few seconds after disengagement or after you have switched off the motor.
- Be careful of flying debris coming from the cutting means.
- Be careful of avoiding violent collisions between the cutting means and foreign objects/obstacles. Kickback may occur if the cutting means comes into contact with an obstacle/object. This contact can cause

a rapid jerk in the opposite direction, pushing the cutting means up and towards the operator. Kickback can cause the operator to lose control of the machine, leading to serious consequences. To avoid kickbacks, take all the appropriate precautions indicated below:

- Firmly hold the machine, with two hands, and place your body and arms in a position that allows you to resist kickback.
- Do not extend the arms too high and do not cut above waist height.
- Only use the cutting means specified by the manufacturer.
- Follow the manufacturer's instructions concerning cutting means maintenance.
- Beware of injuries caused by devices used to cut the line length.

DANGER

If something breaks or an accident occurs during work, turn off the motor immediately and move the machine away to prevent further damage; if an accident occurs with injuries or third parties are injured, carry out the first aid measures most suitable for the situation immediately and contact the medical authorities for any necessary health care. Carefully remove any debris which could cause damage or injury to persons or animals if ignored.

⚠ DANGER

Prolonged exposure to vibrations can cause injuries and neurovascular disorders (also called "Raynaud's syndrome" or "white hand"), especially to people suffering from circulation disorders. The symptoms can regard the hands, wrists and fingers and are shown through loss of sensitivity, torpor, itching, pain and discolouring of or structural changes to the skin. These effects can be worsened by low ambient temperatures and/or by gripping the hand grips excessively tightly. If the symptoms occur, the length of time the machine is used must be reduced and a doctor consulted.

Restrictions of use

- Do not use the machine if you are unable to hold it with both hands or keep steady on your legs while working.
- Never use the machine with damaged, missing or incorrectly positioned guards.
- Don't use the machine if the attachments/tools are not installed in their seats.
- Never disengage, deactivate, remove or tamper with the safety systems/micro switches installed.
- Do not use the power tool if the switch does not turn it on and off. Any power tool that cannot be controlled with the switch is dangerous and must be repaired.
- Do not strain the machine too much and do not use a small machine for heavy-duty work; if you use the right

machine, you will reduce the risk of hazards and improve the quality of your work.

2.5 MAINTENANCE, STORAGE

Ensure regular maintenance and correct storage to maintain machine safety and high performance levels.

Maintenance

- Never use the machine with worn or damaged parts. Faulty or worn-out parts must always be replaced and never repaired.
- Be careful during adjustment of the machine to prevent entrapment of the fingers between moving parts of the cutting means and fixed parts of the machine.

⚠ DANGER

The noise and vibration levels shown in these instructions are the maximum levels when using the machine. The use of an unbalanced cutting element, the excessive speed of movement, or the absence of maintenance have a significant influence on noise emissions and vibrations. Consequently, it is necessary to take preventive steps to eliminate possible damage due to high levels of noise and stress from vibration; maintain the machine well, wear ear protection devices, and take breaks whilst working.

Storage

To reduce fire risks, do not leave containers with debris inside a room.

2.6 BATTERY / BATTERY CHARGER

ATTENTION

The following safety rules complement the safety rules contained in the battery charger manual.

- Only use battery chargers recommended by the manufacturer to recharge batteries. An inadequate battery charger may cause electric shock, overheating or corrosive liquid to leak from the battery.
- Use only batteries specifically designed for your power tool. The use of other batteries may cause injuries and fire risks.
- Make sure that the machine is switched off before inserting the battery. Inserting a battery in a machine which is switched on can cause a fire.
- Keep all unused batteries at a distance from paper clips, coins, keys, nails, screws or other small metal objects as contact with the same can cause short circuits. Short circuits between battery contacts can lead to explosion or fires.
- Do not use the battery charger in places where there are inflammable vapours, substances or on easily inflammable surfaces like paper, fabric, etc. During recharge, the battery charger becomes heated and may cause fire.
- When transporting batteries, make sure the contacts never come into contact with each

other and never use metal containers to transport them.

2.7 ENVIRONMENTAL PROTECTION

Protecting the environment must be a significant and top priority for machine use, to the benefit of civil co-habitation and of the environment that we live in. Avoid being an element of disturbance to the surrounding area. Use this machine at reasonable times of the day only (not early morning or late evening when the noise could cause disturbance). Scrupulously comply with local regulations for the disposal of packaging, deteriorated parts or any elements with a strong environmental impact; this waste must not be disposed of with regular waste, but must be separated and taken to collection centres, which will recycle the materials. Comply with local regulations for the disposal of waste materials. When the machine is withdrawn from service, do not dispose of it in the environment, but take it to a waste disposal facility in accordance with the local regulations in force.



Do not throw electrical equipment away with domestic waste. According to the European Directive 2012/19/EU on electrical and electronic equipment waste and its implementation in compliance with national standards, old electrical equipment must be collected separately, for eco-compatible recycling. If electrical equipment is disposed of in

a landfill or in the ground, the harmful substances can reach the water table and enter the food chain, damaging your health and well-being. For further information on the disposal of this product, contact your dealer or a domestic waste collection service.



At the end of their working life, dispose of batteries safely in an eco-friendly manner. Batteries contain material classified as hazardous for you and the environment. They must be removed and disposed of separately at a facility that accepts lithium-ion batteries.



Separate waste collection of the products and packaging used allows the materials to be recycled and reused. Reuse of recycled materials help to prevent environmental pollution and reduces the demand for raw materials.

2.8 RESIDUAL RISKS

Even when all safety rules are observed, there may still be certain residual risks which cannot be excluded. From the kind and construction of the tool the foreseeable potential endangerments can be:

- Hurlled materials that may injure the eyes;
- Damage of the hearing, if no protection of the ears is carried.

3. ABOUT THE MACHINE

3.1 MACHINE DESCRIPTION AND INTENDED USE

This machine is a garden tool and more precisely a battery-powered portable brush cutter/grass trimmer.

The machine essentially comprises of a motor which drives a cutting means configured in various ways to meet various functions.

The operator is able to sustain the machine with the aid of a harness and can operate the main controls, always keeping at a safe distance from the cutting means.

3.1.1 Intended use

This machine was designed and manufactured for:

- cutting grass and non-woody vegetation with a nylon line enclosed in a cutting line head;
- cutting tall grass, dry branches, twigs and woody shrubs of up to 2cm diameter, with the aid of metal or plastic blades;
- being used by one operator.

3.1.2 Reasonably foreseeable improper use

Examples of improper use may include, but are not limited to (for example):

- using the machine for sweeping, tilting the cutting line head. The power of the motor could throw objects and small stones 15 metres or more, causing damage or injury to people;
- trimming hedges or other jobs in which the cutting means is not used at ground level;
- cutting and chopping trees, bushes and flowers;
- pruning trees;
- using the machine for cutting non-plant material;
- using the machine with the cutting means above the operator's belt level;
- using the machine in public gardens, parks, sports centres, on roadways, fields and woods;
- using cutting means other than those listed in the "Technical Data" table.

3.1.3 Improper use

Any other usage, different than the ones mentioned at par. 3.1.1 may be hazardous and harm persons and/or damage things; therefore, it is deemed improper use.

NOTE

Improper use of the machine will void the warranty and relieves the Manufacturer of any liability, placing all responsibility for damage or injury, to him/herself or third parties, on the user.

3.1.4 Type of users

This machine is intended for use by consumers, i.e. non-professional operators. It is intended for "hobby-related activities".

3.2 SAFETY SIGNS

The machine has various symbols on it (fig. 2). Their function is to remind the operator of the correct conduct for use, with due care and caution.

Meanings of the symbols:



ATTENTION - DANGER
The failure to use this machine correctly can be hazardous for oneself and others.



Read the owner's manual before using the machine.



Use safety goggles.



Use hearing protections.



Use safety helmet.



Wear safety gloves.



Wear safety footwear.



PROJECTION HAZARD
Be careful of flying debris projected by the cutting means, that can cause serious injuries to persons or damage to things.



PROJECTION HAZARD
People or pets must be kept at least 15m away when using the machine!



Beware of blade kickback.



Do not use circular saw blades.



Do not leave the machine in the rain (or in damp conditions).

DANGER

Using circular saw blades on models that are not designed for them exposes the user to the risk of very serious or even fatal injuries.

ATTENTION

Any damaged or illegible decals must be replaced. Order replacement decals from an Authorised Service Centre.

3.3 PRODUCT IDENTIFICATION LABEL

The product identification label provides the following data (fig. 1):

3. Sound power level
4. Conformity marking
5. Year of manufacture
6. Type of machine
7. Manufacturer's reference model
8. Serial number
9. Name and address of Manufacturer
10. Article code

Write the identification data of the machine in the specific space on the label on the back of the cover page.

ATTENTION

State the identification data on the product identification label whenever you contact an Authorised Service Centre.

NOTE

An example of the Declaration of Conformity is provided on the last pages of this manual.

3.4 MAIN COMPONENTS

The machine is composed of a series of main components that have the following functions (Fig.1):

- A. **Engine:** drives cutting means motion via transmission shaft and angle transmission.
- B. **Rod:** it connects the rear hand grip to the power unit.
- C. **Angle transmission:** final part of the transmission tube that transmits motion to the cutting means.
- D. **Cutting means:** the element designed to cut vegetation
 1. **Cutting line head:** nylon line cutting means.
 2. **Blade:** metal disc cutting means (in the box).
- E. **Cutting means guard:** it is a safety device which prevents objects drawn up by the cutting means from being hurled away from the machine.
- F. **Handle bar:** "cow horn" handle bar placed transversely to the rod and asymmetrically to it; used to control the machine; the main on/off commands are located on the right side.
- G. **Machine support:** a piece which, when attached to the battery backpack, helps supporting the machine during operation.
- H. **Connection point:** point in which the machine is attached to the battery backpack.
- I. **Blade protection** (for machine transport and handling): protects against accidental contact with the cutting means that can cause serious injuries.
- J. **Battery backpack** (attachment on request, par. 15.3): device in which the batteries are placed.
- K. **Battery:** (attachment on request. 15.1) device that supplies electric power to the tool.
- L. **Battery charger** (accessory available upon request, paragraph 15.2): device used to recharge the battery. Three battery

charger models are available: **L1** (fast battery charge); **L2** (standard battery charge), **L3** (dual battery charge).

- M. **Connection cable:** cable used to connect the machine to the battery backpack.

4. ASSEMBLY

DANGER

The safety regulations to be followed are described in chapter 2. Strictly comply with these instructions to avoid serious risks or hazards.

For storage and transport purposes, some components of the machine are not installed in the factory and have to be assembled after unpacking. Follow the instructions below.

ATTENTION

Unpacking and completing the assembly should be done on a flat and stable surface, with enough space for moving the machine and its packaging, always making use of suitable equipment. Do not use the machine until all the instructions provided in the "ASSEMBLY" section have been carried out.

4.1 ASSEMBLY COMPONENTS

The packaging includes assembly components.

4.1.1 Unpacking

1. Carefully open the packaging, paying attention not to lose components.
2. Consult the documentation in the box, including these instructions.
3. Remove all the unassembled parts from the box.
4. Remove the machine from the box.
5. Dispose of the box and packaging in compliance with local regulations.

DANGER

Before assembly, check that the machine is not connected to the battery backpack.

4.2 FITTING THE HANDLE BAR

1. Fit the handle (Fig. 3.A) in its seat on the handlebar (Fig. 3.B).
2. Tighten the handle with the screw (Fig. 3.C).
3. Insert the spring on the handlebar support (Fig. 4.A).

4. Place the handlebar on the spring making sure that the controls are on the right.
5. Insert the screw without tightening it (Fig. 3.B).
6. Arrange the handlebar in the most comfortable working position and lock it using the lever (Fig. 4.C), fully tightening the screw.

NOTE

By raising the handlebar adjustment lever (Fig. 3.B), the handlebar can be rotated to reduce its occupied space during storage.

4.3 FITTING/REMOVING CUTTING MEANS AND SPECIFIC GUARDS

DANGER

Wear safety gloves.

DANGER

Whenever you have to change the cutting means, disconnect the machine from the battery backpack and disassemble all its elements.

4.3.1 Selecting the cutting means

Choose the most suitable cutting means for the job to be done, according to these general instructions:

- **the cutting line head** can cut tall grass and non-woody vegetation near fences, walls, foundations, pavements, around trees, etc. or to clear a particular area of the garden;
- **the blade** is designed to cut resistant grass on large areas.

4.3.2 Fitting the guard on the cutting means

1. Place the guard (Fig. 4.A) in line with the holes on the angle transmission (Fig. 4.B).
2. Place the support plate on the cutting means guard (Fig. 4.D).
3. Fully tighten the screws (Fig. 4.C).

NOTE

The following symbol can be found on the cutting means guard:



It indicates the rotation direction of the cutting means.

4.3.3 Fitting and removing cutting means

4.3.3.a Fitting the cutting line head

1. Fit the inner ring nut (Fig.5.A) on the shaft in the indicated direction, making sure that the grooves are perfectly coupled with those on the angle transmission (Fig. 5.B).
2. Insert the wrench supplied (Fig. 5.C) into the appropriate hole on the angle transmission and rotate the ring nut by hand by pushing the wrench (Fig. 5.C) until it engages and blocks the rotation.
3. Fit the line holder head (Fig. 5.D) by screwing it anticlockwise.
4. Remove the wrench (Fig. 5.C) to reset rotation.

ATTENTION

When using the line holder head, the line cutting knife must always be installed (Fig. 6.A). The machine is delivered with a cutting diameter set to 38cm.

4.3.3.b Removing cutting wire head

1. Insert the wrench supplied (Fig. 5.C) into the appropriate hole on the angle transmission and rotate the ring nut by hand by pushing the wrench (Fig. 5.C) until it engages and blocks the rotation.
2. Remove the line holder head (Fig. 5.F) by unscrewing it clockwise.

4.3.3.c Blade fitting

DANGER

Apply the guard to the blade.

1. Mount the blade (Fig. 7.B) and the outer ring nut (Fig. 7.C) with the wider part facing the blade.
2. Insert the wrench supplied (Fig. 7.A) into the appropriate hole on the transmission and rotate the blade (Fig. 7.B) by hand by pushing the wrench (Fig. 7.A) until it engages in the hole of the angle transmission and blocks its rotation.
3. Mount the cup (Fig. 7.D) and screw the nut (Fig. 7.E), tightening until the end.
4. Remove the wrench (Fig. 7.A) to resume rotation.

4.3.3.d Blade removal

DANGER

Apply the guard to the blade.

1. Insert the wrench supplied (Fig. 7.A) into the appropriate hole on the transmission and rotate the blade (Fig. 7.B) by hand by pushing the wrench (Fig. 7.A) until it engages in the hole of the angle transmission and blocks its rotation.
2. Unscrew the nut (Fig. 7.E) and remove the cup (Fig. 7.D).
3. Remove the outer ring nut (Fig. 7.C), then remove the blade (Fig. 7.B).

4.4 FITTING THE BATTERY BACKPACK

The battery backpack is delivered already assembled (Fig. 1.J) and can be released from the strap support (Fig. 8) and carried by hand. To release the battery backpack, press on the two upper buttons (Fig. 8.A). The battery compartments are located on both sides of the backpack (Fig. 9). The following can be found on the right side of the backpack:

- cable socket (Fig. 10.A)
- battery selector (Fig. 10.B)
- one USB port for charging other devices (e.g. mobile phones) (Fig. 10.C)

To avoid any loose cables, there are grooves on both sides and at the rear, in which the power cable can be inserted.

5. CONTROLS

5.1 THROTTLE CONTROL LEVER

Used to start and regulate cutting means speed.

The throttle safety lever allows the throttle control lever to be used (Fig. 11.A); this is only possible if the throttle safety button is pressed at the same time (Fig. 11.B).

The cutting means stops automatically when the throttle safety lever is released.

5.2 THROTTLE SAFETY BUTTON

The throttle safety button (Fig. 11.B) allows the throttle control lever to be used (Fig. 11.A).

6. USING THE MACHINE

DANGER

The safety regulations to be followed are described in chapter 2. Strictly comply with these instructions to avoid serious risks or hazards.

6.1 PRELIMINARY OPERATIONS

Before starting work it is necessary to carry out several checks and operations to ensure you can work efficiently and in maximum safety:

1. place the machine in a stable horizontal position on the ground;
2. choose the most suitable cutting means for the job to be done (par. 4.3.1);
3. check the battery (par. 6.1.1);
4. Wear the battery backpack correctly (par 6.1.2);
5. prepare the machine support (par. 6.1.3).

6.1.1 Checking the battery

The machine is supplied without the battery. Purchase the battery with the capacity that most suits your operational requirements and fully charge it according to the instructions in the battery charger manual. The list of approved batteries for this machine can be found in the "Technical Data" table. Before each use:

- Check the battery charge status by following the instructions provided in the battery charger manual.

6.1.2 Using the battery backpack

1. Insert the battery in one of the compartments of the battery backpack and push it completely, until hearing the click that signals its locking in position, ensuring thus the electrical contact (Fig. 9).
2. Connect the cable to the specific socket and rotate it until hearing the specific click that signals its locking in position, ensuring thus the electrical contact (Fig. 10.A).
3. Adjust the straps (Fig. 12.A).
4. Close the harness at the front (Fig. 12.B).
5. Connect the cable to the machine (Fig. 13).

6.1.3 Using the machine support

DANGER

Frequently check the efficiency of the quick release (Fig. 12.C) to guarantee

that the machine can be quickly released from the straps in case of danger.

The machine support must be put on before connecting the machine to the specific coupling and the belt must be adjusted according to the height and build of the operator.

- Fasten the clip (Fig. 12.D) to the specific coupling located on the command rod (Fig. 1.H).
- If necessary, disengage the quick release (Fig. 12.C) to detach the harness from the machine.

6.2 SAFETY CHECKS

Run the following safety checks and ensure that the results correspond to those outlined in the tables.

DANGER

Always carry out the safety checks before use. If any of the results fail to match the indications provided in the tables below, do not use the machine! Take it to a service centre to be checked and repaired if necessary.

6.2.1 General check

Object	Result
Hand grips (Fig. 1.F).	Clean, dry and fixed firmly to the machine.
Cutting means guard (Fig. 1.E).	Correctly and securely fit to the machine, not worn/deteriorated or damaged.
Connection point of the machine support (Fig. 1.H).	Correctly positioned.
Screws on the machine and the cutting means.	Correctly tightened (not loose).
Cutting means (Fig. 1.D.1; Fig. 1.D.2).	Clean, not damaged or worn.
Metal blade (if fitted) (Fig. 1.D.2).	Sharp.
Battery (Fig. 1.K)	No damage to the casing, no liquid leakage.
Cooling air ducts (paragraph 7.3).	Not clogged.
Machine.	No signs of damage or wear.
Connection cable of the battery backpack (Fig. 1.M).	No signs of damage.

Throttle control lever (Fig. 11.A), throttle safety button (Fig. 11.B).	The levers must move freely and not be forced.
Test operation.	No abnormal vibrations. No abnormal sound.

6.2.2 Machine operating test

Action	Result
1. Insert the battery in one of the compartments of the battery backpack (par. 7.2.3). 2. Use the connection cable to connect the machine to the battery backpack (Fig. 13). 3. Select the battery using the selector (Fig. 10.B).	The cutting means must not move.
Operate the throttle control lever (Fig. 11.A) (without pressing the throttle safety button).	The throttle control lever remains blocked.
Operate the throttle control lever (Fig. 11.A) and the throttle safety button (Fig. 11.B).	The throttle control lever must move freely and not be forced. The cutting means moves.
Release the throttle control lever (Fig. 11.A) and throttle safety button (Fig. 11.B).	The levers and the button should return automatically and rapidly to the neutral position and the cutting means should stop.

6.3 START-UP

1. Remove the blade guard (Fig. 1.J) (if fitted);
2. adopt a firm and well-balanced position;
3. Make sure the cutting means is not touching the ground or any other object;
4. use the connection cable to connect the machine to the battery backpack (Fig. 13);
5. select the battery using the selector (Fig. 10.B);
6. operate the throttle control lever (Fig. 11.A) and the throttle safety button (Fig. 11.B) at the same time.

6.4 OPERATION

Before starting any tasks for the first time, is it recommended to get to know the machine, learn the most suitable cutting techniques, make sure you are wearing the harness correctly, hold the machine firmly and perform the movements required by the job.

To use the machine proceed as follows:

- always connect the machine to the correctly fitted battery backpack (par. 6.1.2).
- when working, the machine must always be firmly held in both hands, keeping the power unit on the right of the body and the cutting unit below the line of the belt (Fig. 14).

NOTE

During operation, the battery is protected against total drainage with a protection device that switches off the machine and inhibits its operation.

NOTE

The battery power reserve (and therefore the surface covered by vegetation that can be mowed before recharging is required) depends on many factors described at par. 7.2.1.

6.4.1 Work techniques

6.4.1.a Cutting line head

DANGER

Use ONLY nylon lines. The use of metal lines, plastic coated metal lines and/or lines that are not suitable for the head can cause serious injuries and wounds.

a. Cutting motion (Scything)

Proceed at a steady pace, with a circular motion similar to a traditional scythe, without tilting the cutting line head during the operation (Fig. 15).

Start cutting at the correct height in a small area, so as to achieve a uniform cutting height keeping the cutting line head at a constant distance from the ground.

For heavier cutting it can be useful to tilt the cutting line head to the left by about 30°.

DANGER

Do not work in this way if there is the possibility of causing objects to be thrown, which could harm people, animals or cause damage.

b. Precision cutting (Trimming)

Keep the machine slightly tilted so that the lower part of the cutting line head does not touch the ground and the cutting line is at the required point, always keeping the cutting means at a distance from the operator.

c. Cutting near fences/foundations

Move the cutting line head slowly towards fences, posts, rocks, walls, etc. without hitting them hard (Fig. 16).

If the line strikes a solid object it could break or become worn; if it gets tangled in a fence it could break suddenly.

In any case, cutting around pavements, foundations, walls, etc. can cause greater wear than normal to the line.

d. Cutting around trees

Walk round the tree from left to right, approaching the trunk slowly so as not to strike the tree with the line and keeping the cutting line head tilted forward slightly (Fig. 17).

Remember that the nylon line could lop off or damage small shrubs and that the impact of the nylon line against the trunk of bushes or trees with soft bark could seriously damage the plant.

6.4.1.b Blade

Proceed using the machine as a traditional scythe, with a circular movement of about 60-90°, thus moving outside the vegetation area, and so on (Fig. 18).

6.4.2 Adjusting the length of the cutting line head during work

This machine is fitted with an automatic line release head.

Head line length should be adjusted:

- when the line is consumed and becomes shorter;
- when engine rotation seems higher than normal;
- when cutting efficiency seems reduced.

To release new line:

- hit the cutting line head against the ground (Fig. 19) with the throttle control lever pressed fully down;
- line is automatically released and the line cutting knife (Fig. 6.A) cuts the excess length.

6.5 OPERATING SUGGESTIONS

During use, it is advisable to remove cut vegetation wrapped around the machine at regular intervals to avoid the engine overheating (Fig. 1.A) caused by grass trapped under the cutting means guard (Fig. 1.E).

Proceed as follows:

1. stop the machine (par. 6.6);

2. disconnect the machine from the battery backpack (Fig. 20);
3. wear protective gloves;
4. remove the entangled grass with a screwdriver to allow the motor to cool properly.

6.6 STOP

To stop the machine:

1. Release the throttle control lever (Fig. 11.A);
2. release the throttle safety button (Fig. 11.B);
3. Wait until the cutting means stops.

DANGER

After having stopped the machine, it will take a few seconds for the cutting means to stop.

ATTENTION

Always stop the machine when moving between different work areas.

DANGER

Do not keep your finger on the throttle safety button when moving the machine to avoid the accidental start of the machine.

6.7 AFTER USE

1. Move the battery backpack selector (Fig. 10.B) to "OFF".
2. Disconnect the machine from the battery backpack (Fig. 20).
3. Remove the battery backpack.
4. Remove the battery from its housing and recharge it (para. 7.2.2).
5. Fit the blade guard (Fig. 1.J) when the cutting means is stopped.
6. Allow the engine to cool before storing in an enclosed space.
7. Clean (par. 7.3).
8. Make sure there are no loose or damaged components. If necessary, replace the damaged components and tighten any screws and loose bolts or contact the authorised service centre.

DANGER

Always disconnect the machine from the battery backpack (Fig. 20) and fit the blade guard whenever the machine is unused or left unattended.

7. ROUTINE MAINTENANCE

7.1 GENERAL INFORMATION

DANGER

The safety regulations to be followed are described in chapter 2. Strictly comply with these instructions to avoid serious risks or hazards.

Before commencing any inspections, cleaning or maintenance/adjustments on the machine:

1. stop the machine;
 2. Wait until the cutting means stops;
 3. Disconnect the machine from the battery backpack (Fig. 20);
 4. remove the battery from its housing and recharge it (para. 7.2.2);
 5. Fit the blade guard (Fig. 1.I), if no interventions are required on the blade;
 6. Wait until the engine has properly cooled down;
 7. read the relevant instructions;
 8. Use suitable clothing, protective gloves and safety goggles.
- The frequency and types of maintenance are summarised in the "Maintenance Table" (chapter 13). The table will help you maintain your machine's safety and performance. It summarises the main interventions to be made and the frequency applicable to each of them. Carry out the relevant task as soon as it is scheduled to be performed.
 - The use of non-original parts and accessories could have negative effects on machine operation and safety. The manufacturer declines any responsibility for damage or injury caused by said products.
 - Genuine spare parts are supplied by Authorised Assistance Centres and Dealers.

ATTENTION

Any maintenance and adjustment operations not described in this manual must be carried out by the local Dealer or Authorised Service Centre.

7.2 BATTERY

7.2.1 Battery power reserve

Battery power reserve (and therefore the cuttable vegetation area before recharging is required) mainly depends on:

- Environmental factors, that cause higher energy requirements:

- cutting, high, wet vegetation;
- operator behaviour that should be avoided:
 - switching the machine on and off frequently whilst working;
 - using a cutting means or cutting technique that is unsuitable for the work to be performed (par. 6.4);
 - cutting speed unsuitable for the condition of the grass to be cut.

To optimise battery power reserve it is always recommended to:

- cut the grass when dry;
- set a cutting speed suitable for the condition of the grass;
- use the most appropriate cutting means and technique for the work to be performed.

NOTE

The battery charge level can be monitored by checking the specific indicator located on the hand grip (Fig. 11.C).

If the need arises to use the machine for sessions which exceed the capability of a standard battery, it is possible to:

- choose the second battery (if any) from the battery backpack (Fig. 10.B);
- purchase additional standard batteries to immediately replace the discharged battery, without compromising the continuity of operations;
- purchase a battery with an extended power reserve compared to the standard version (para. 15.1).

7.2.2 Battery removal and recharging

1. Press the locking button located on the battery (Fig. 21.A) and remove the battery (Fig. 21.B);
2. Fit the battery (Fig. 22.A) in the battery charger compartment (Fig. 22.B);
3. Connect the battery charger (Fig. 22.B) to a power socket with the voltage indicated on the rating plate;
4. Fully charge the battery according to the instructions in the battery charger manual.

NOTE

The battery is equipped with a protection device that inhibits recharging if the environmental temperature is not between 0 and +45°C.

NOTE

The battery can be charged at any time, even partially, with no risk of damaging it.

7.2.3 Refitting the battery on the machine

When recharging is completed:

1. Remove the battery (Fig. 23.A) from the housing in the battery charger (do not keep charging when recharging is completed);
2. Disconnect the battery charger (Fig. 23.B) from the electrical mains;
3. Insert the battery (Fig. 9) in one of the compartments of the battery backpack and push it completely, until hearing the click that signals its locking in position, ensuring thus the electrical contact.

7.3 CLEANING THE MACHINE AND THE ENGINE

- Always clean the machine after use with a damp cloth dipped in neutral detergent.
- Remove all traces of humidity using a soft damp cloth. Humidity can generate risks of electric shocks.
- Do not use aggressive detergents or solvents to clean the plastic parts or hand grips.
- To reduce fire hazards, keep the machine and, in particular, the motor free of grass, leaves, or excessive grease.
- To avoid overheating and damage to the engine, always keep the cooling air vents (Fig. 1.A) clean and free of debris.
- Do not spray water onto the motor and electrical components and prevent them from getting wet.

7.4 NUTS AND BOLTS

- Keep all nuts, bolts and screws tight to be sure the equipment is in safe working condition.
- Check regularly that the handles are fixed firmly.

8. OCCASIONAL MAINTENANCE

8.1 CUTTING MEANS MAINTENANCE

Cutting means displaying the code indicated on the Technical Data table should only be used on this machine.

NOTE

Given product evolution, the cutting means mentioned in the "Technical Data" table may be replaced in time with others having similar interchangeable and operating safety features.

DANGER

Do not touch the cutting means if the machine is not disconnected from the battery backpack and if the cutting means is not completely at a standstill.

DANGER

Warning! Risk of injuries due to moving parts!

8.1.1 Blade sharpening/balancing

DANGER

For safety reasons, sharpening and balancing should be performed by an Authorised Service Centre with suitable skills and equipment for the job; without risking any damage to the blade which would make it unsafe when used.

Blades can be used on both sides. When one side of the points is worn, the blade can be turned and the other side used. When both sides of the points are worn, have them sharpened.

8.1.2 Blade replacement

ATTENTION

The blade must never be repaired, but must be replaced as soon as signs of breaking are noted or the sharpening limit is exceeded:

For replacement procedures, see chapter 4.3

8.1.3 Replacing the cutting line head

1. Only use lines of 2mm in diameter and cut the new line to the indicated length (Fig. 24.A).
2. Turn the winding knob (Fig. 25.A) to align the reference on the knob (Fig. 26.B) with the reference on the head body (Fig. 26.C).
3. Insert one end of the line (Fig. 26.D) in one of the two output holes and pass the line through the opposite hole.
4. Align the lines that exit the two holes evenly.

5. Turn the winding knob (Fig. 25.A) following the direction of the arrows to wind the line, being careful to leave about 150 mm from both holes (Fig. 25.B).

If old line is left in the head or if broken inside it, remove as described below:

1. Press the tabs on the sides of the cutting line head, where marked "PUSH" (Fig. 27.A), and detach the lower part of the head (Fig. 27.B);
2. Remove the line left inside;
3. Replace the reel (Fig. 28.A) in its housing;
4. Close the head by fastening the tabs (Fig. 28.B) in the slots (Fig. 28.C), pushing them fully in until they click to lock the bottom part of the head (Fig. 28.D) in place.

8.2 SHARPENING THE WIRE CUTTING BLADE

1. Remove the line cutting knife (Fig. 6.A) from the cutting means guard (Fig. 6.B) by unscrewing the screws (Fig. 6.C).
2. Fix the line cutting knife in a vice and sharpen it using a flat file, being careful to retain the original cutting angle.
3. Refit the line cutting knife (Fig. 6.A) on the cutting means guard (Fig. 6.B) and tighten the screws (Fig. 6.C).

9. STORAGE

DANGER

The safety rules to be followed during storage operations are described at par. 2. Strictly observe these indications to avoid serious risks or dangers.

9.1 STORING

When the machine is to be stored away:

1. Disconnect the machine from the battery backpack;
2. Remove the battery from its compartment and recharge it;
3. when the cutting means has halted, fit the blade guard;
4. allow the engine to cool before storing in an enclosed space;
5. Clean (para. 7.3);
6. Make sure there are no loose or damaged components. If necessary, replace any damaged components and tighten any screws and loose bolts or contact the authorised service centre;
7. Store the machine:

- in a dry place;
- protected from inclement weather;
- in a place out of children's reach;
- making sure that keys or tools used for maintenance are removed.

9.2 STORING THE BATTERY

The battery must be kept in a cool, shaded place without humidity.

NOTE

In case of prolonged inactivity, recharge the battery every two months to prolong its service life.

10. HANDLING AND TRANSPORT

Whenever the machine is to be handled, lifted, transported or tilted you must:

1. stop the machine;
2. Wait until the cutting means stops;
3. Disconnect the machine from the battery backpack;
4. Remove the battery from its compartment and recharge it;
5. Apply the guard to the blade;
6. Wait until the engine has properly cooled down;
7. wear protective work gloves;
8. Only hold the machine using the handle bar and direct the cutting means in the opposite direction to that used during operations.

When transporting the machine on a vehicle, always:

- Properly secure the machine;
- position it so that it does not cause a hazard to anyone.

11. ASSISTANCE AND REPAIRS

This manual provides all the necessary information to run the machine and for correct basic maintenance operations which can be performed by the user. Any regulations and maintenance operations not described herein must be carried out by your Dealer or Authorised Service Centre, which have the necessary knowledge and equipment to ensure that the work is carried out correctly, maintaining the correct degree of safety and the original operating conditions of the machine.

Any operations performed in unauthorised centres or by unqualified persons will totally invalidate the warranty and all obligations and responsibilities of the manufacturer.

- Only Authorised Service Centres can carry out guaranteed repairs and maintenance.
- The Authorised Service Centres only use genuine spare parts. Genuine spare parts and attachments have been designed specifically for machines.
- Non-genuine spare parts and accessories are not approved. Use of non-genuine spare parts and accessories cause the warranty to be voided.
- It is advisable to send your machine once a year to an Authorised Service Centre for servicing, assistance and safety device inspection.

12. WARRANTY COVERAGE

The warranty covers all material and manufacturing defects. The user must follow all the instructions provided in the accompanying documentation.

The warranty does not cover damage caused by:

- Failure to become familiar with the documentation accompanying the machine.
- Carelessness.
- Incorrect or prohibited use or assembly.
- Use of non-genuine spare parts.
- Use of attachments not supplied or not approved by the manufacturer.

The warranty does not cover:

- Normal wear and tear of consumables, such as cutting means, safety bolts.
- Normal wear and tear.

The purchaser is protected by his or her own national legislation. The purchaser's rights under the national laws or his or her own country are not in any way restricted by this warranty.

13. MAINTENANCE TABLE

Intervention	Frequency	Notes
MACHINE		
Check the status of the connection cable of the battery backpack.	Before each use.	-
Check all fasteners.	Before each use.	para. 7.4
Safety checks/command check.	Before each use.	para. 6.2
Check the cutting means guard.	Before each use.	par. 6.2.1
Check the cutting means.	Before each use.	par. 6.2.1
Check the battery charge status.	Before each use.	*
Recharge the battery.	After each use.	para. 7.2.2 *
Clean the machine and the engine.	After each use.	para. 7.3
Checking for any damage to the machine. If necessary, contact the authorised service centre.	After each use.	-

* Refer to the battery/battery charger manual.

14. TROUBLESHOOTING

PROBLEM	PROBABLE CAUSE	SOLUTION
1. The motor shuts down whilst working.	The connection cable is not correctly inserted in the battery backpack.	Check the correct connection of the cable to the machine and to the battery backpack.
	Battery is not inserted correctly.	Make sure that the battery is correctly inserted in the battery backpack (par. 7.2.3).
	Low battery.	Check the charge status and recharge the battery (par. 7.2.2), or, if available, choose another battery.
	Machine damaged.	Do not use the machine. Disconnect the machine from the battery backpack and contact an Authorised Service Centre.
2. The cutting means does not rotate even if the throttle control lever (Fig. 11.A) and throttle safety button (Fig. 11.B) are engaged.	Battery is not inserted or is inserted incorrectly.	Make sure that the battery is inserted correctly (par. 7.2.3).
	Incorrect connection to the battery backpack.	Check that the machine is correctly connected to the battery backpack.
	Low battery.	Check the battery status and recharge if necessary (par. 7.2.2).
	Battery backpack selector to "OFF".	Check that the selector (Fig. 10.B) is placed on one of the batteries inside the battery backpack.
	The throttle control lever is faulty or the machine is damaged.	Do not use the machine. Stop the machine immediately, disconnect it from the battery backpack and contact an Authorised Service Centre.
3. Engine overheating.	Grass trapped under the cutting means guard.	Remove trapped grass (par. 6.5).
4. Mowing is difficult.	The cutting means is not in good condition.	Proceed with the cutting means maintenance (par. 8.1).

If problems persist after having performed the operations described above, contact your dealer.

PROBLEM	PROBABLE CAUSE	SOLUTION
5. Grass accumulates around the shaft housing and line holder head.	Too high grass is being cut close to the ground.	Cut tall grass with a sweeping motion to avoid build up.
6. The line is not released when the line holder head hits the ground.	The line is stuck.	Lubricate with silicone spray.
	Not enough line on the reel or reel empty.	Replace the line (chapter 8.1.3.).
	The line is worn and too short.	Pull the line whilst pressing the release button.
	The line is tangled on the reel or broken inside the reel.	Remove the line from the reel and rewind it (chapter 8.1.3.).
7. The cutting means comes into contact with a foreign body.	-	Stop the machine, disconnect it from the battery backpack and: <ul style="list-style-type: none"> • inspect for damage; • check for and tighten any loose parts; • have any damaged parts replaced or repaired with parts having equivalent specifications.
8. Excessive noise and/or vibration is experienced whilst working.	Loose or damaged parts.	Stop the machine, disconnect it from the battery backpack and: <ul style="list-style-type: none"> • inspect for damage; • check for and tighten any loose parts; • have any damaged parts replaced or repaired with parts having equivalent specifications.
9. The machine emits smoke during operation.	Machine damaged.	Do not use the machine. Immediately stop the machine, disconnect it from the battery backpack and contact an Authorised Service Centre.
10. Battery power reserve is low.	Severe working conditions requiring greater current absorption.	Optimise operations (par. 7.2.1).
	Battery is insufficient for operating requirements.	Use a second battery or an extended battery (par. 15.1).
	Decrease in battery capacity.	Purchase a new battery.
11. The battery charger is not charging the battery.	Battery is not correctly inserted in the battery charger.	Check it is correctly inserted (par. 7.2.2).
	Unsuitable environmental conditions.	Recharge the battery in places with suitable temperatures (see battery/ battery charger instruction manual).
	Dirty contacts.	Clean the contacts.
	The battery charger is not energised.	Check it is plugged in and the power socket is energised.
	Faulty battery charger.	Replace with an original spare part. If the problem persists, refer to the battery/battery charger manual.

If problems persist after having performed the operations described above, contact your dealer.

15. ACCESSORIES ON REQUEST

15.1 BATTERIES

Different capacity batteries are available to suit specific operating requirements. The list of approved batteries for this machine can be found in the "Technical Data" table.

15.2 BATTERY CHARGER

Device used to recharge the battery: fast (Fig. 29.A), standard (Fig. 29.B), dual (Fig. 29.C).

15.3 BATTERY BACKPACK

The device is used to place the two batteries and provides the electrical power required for the operation of the machine. It is provided with a cable used for the connection to the machine (Fig. 1.M) and with a selector (Fig. 10.B) used to disconnect the power supply ("OFF" position) or to select one of the two batteries (position "1" and "2").

DICHIARAZIONE CE DI CONFORMITÀ (Istruzioni Originali)
(Direttiva Macchine 2006/42/CE, Allegato II, parte A)

1. **La Società:** ST. S.p.A. – Via del Lavoro, 6 – 31033 Castelfranco Veneto (TV) – Italy
2. Dichiara sotto la propria responsabilità, che la macchina: Decespugliatore/tagliaerba portatile, taglio erba

- a) Tipo / Modello Base
b) Mese/Anno di costruzione
c) Matricola

BC 900 D Li 48

- d) Motore a batteria

3. É conforme alle specifiche delle direttive:

- MD: 2006/42/EC
- e) Ente Certificatore /
- f) Esame CE del tipo: /

- OND: 2000/14/EC, ANNEX V
- D. Lgs. 262/2002, ANNEX V (Italy)
- e) Ente Certificatore: /

- EMCD: 2014/30/EU
- RohS II: 2011/65/EU - 2015/863/EU

4. Riferimento alle Norme armonizzate:

EN 60335-1:2012+A2:2019
EN 50636-2-91:2014
EN ISO 11806-1:2011
EN 60745-1:2009+A11:2010
EN 62233:2008

EN 55014-1:2017
EN 55014-2:2015
EN 61000-3-2:2019
EN 61000-3-3:2013+A1:2019
EN IEC 63000:2018

- | | | |
|--|------|-------|
| g) Livello di potenza sonora misurato | 93,4 | dB(A) |
| h) Livello di potenza sonora garantito | 96 | dB(A) |
| k) Potenza installata | / | kW |

- n) Persona autorizzata a costituire il Fascicolo Tecnico:

ST. S.p.A.
Via del Lavoro, 6
31033 Castelfranco Veneto (TV) - Italia

- o) Castelfranco V.to, 13.11.2020

CEO Stiga Group
Sean Robinson



IT • Il contenuto e le immagini del presente manuale d'uso sono stati realizzati per conto di ST. S.p.A. e sono tutelati da diritto d'autore – È vietata ogni riproduzione o alterazione anche parziale non autorizzata del documento.

BG • Съдържанието и изображенията в настоящото ръководство са извършени за ST. S.p.A. и са защитени с авторски права – Забранява се всяко неотризирано възпроизвеждане или промяна, дори и отчасти на документа.

BS • Sadržaj i slike iz ovog korisničkog priručnika napravljeni su isključivo za ST. S.p.A. i zaštićeni su autorskim pravima – zabranjena je svaka neovlaštena reprodukcija ili izmjena dokumenta, djelomično ili u potpunosti.

CS • Obsah a obrázky v tomto návodu k použití byly zpracovány jménem společnosti ST. S.p.A. a jsou chráněny autorským právem – Reprodukce či nepovolené pozměňování tohoto dokumentu, a to i částečné, je zakázáno.

DA • Indhold og illustrationer i denne vejledning er blevet skabt på vegne af ST. S.p.A. og er beskyttet af ophavsret – Enhver gengivelse eller ændring, også delvis, af dokumentet uden autorisation hertil er forbudt.

DE • Inhalt und Bilder dieser Bedienungsanleitung wurden im Namen von ST. S.p.A. erstellt und sind urheberrechtlich geschützt – Jede nicht genehmigte Vervielfältigung oder Veränderung, auch auszugsweise, dieses Dokuments ist verboten.

EL • Το περιεχόμενο και οι εικόνες στο παρόν εγχειρίδιο χρήσης δημιουργήθηκαν για λογαριασμό της εταιρείας ST. S.p.A. και προστατεύονται από πνευματικά δικαιώματα – Απαγορεύεται οποιαδήποτε αναπαραγωγή ή τροποποίηση, έστω και μερική, του εγχειρίδιου χωρίς έγκριση.

EN • The content and images in this User Manual were produced expressly for ST. S.p.A. and are protected by copyright – any unauthorised reproduction or modification to the document, either partially or in full, is prohibited.

ES • El contenido y las imágenes del presente manual de uso han sido creados por ST. S.p.A. y están protegidos por los derechos de autor – Se prohíbe toda reproducción o modificación, incluso parcial, no autorizada del documento.

ET • Käesoleva kasutusjuhendi sisu ja kujutised on toodetud konkreetselt ettevõttele ST. S.p.A. ja neile rakendub autoriõigusseseadus – dokumendi igasugune osaline või täielik ilma loata reprodutseerimine või muutmine on keelatud.

FI • Tämän käyttöoppaan sisältö ja kuvat on valmistettu ST. S.p.A. -yhtiön toimesta ja niitä suojaa tekijänoikeuslaki. – Asiakirjan kaikenlainen kopioiminen tai muuttaminen, osittainkin, on kielletty ilman erityistä lupaa.

FR • Le contenu et les images du présent manuel d'utilisation ont été réalisés pour le compte de ST. S.p.A. et sont protégés par un droit d'auteur – Toute reproduction ou modification non autorisée, même partielle, du document, est interdite.

HR • Sadržaj i slike u ovom priručniku za uporabu izrađeni su za tvrtku ST. S.p.A. te su obuhvaćeni autorskim pravima – Zabranjuje se neovlašteno umnožavanje ili prilagodba, djelomična ili u cijelosti, ovog dokumenta.

HU • Ennek a használati útmutatónak a tartalma és a benne szereplő képek kizárólag a ST. S.p.A. számára készültek és szerzői joggal védettek – tilos a dokumentum bármely részének vagy egészének engedély nélküli sokszorosítása és módosítása.

LT • Šio naudotojų vadovo turinys ir paveikslėliai skirti tik „ST. S.p.A.“ ir yra saugomi autorių teisėmis – dokumentą atgaminti ar modifikuoti, visiškai arba iš dalies, yra draudžiami.

LV • Šis lietotāja rokasgrāmatas saturs un attēli ir veidoti tikai ST. S.p.A. un ir aizsargāti ar autortiesībām. Jebkāda dokumenta vai tā daļas prettiesiska kopēšana vai pārveide ir stingri aizliegta.

MK • Содржината и сликите во Упатството за корисникот се подготвени исклучиво за ST. S.p.A. и се заштитени со авторски права – забрането е секое делумно или целосно неовластено репродуцирање или измена на документот.

NL • De inhoud en de afbeeldingen van deze gebruikshandleiding werden gerealiseerd voor rekening van ST. S.p.A. en zijn beschermd door het auteursrecht – Elke niet-geautoriseerde reproductie of wijziging, ook gedeeltelijke, van het document is verboden.

NO • Innholdet og bildene i denne brukerveiledningen er utført på oppdrag fra ST. S.p.A. og er beskyttet ved opphavsrett – Enhver gjengivelse eller endring, selv kun delvis, er forbudt.

PL • Treść oraz ilustracje zawarte w niniejszej instrukcji obsługi powstały na zlecenie spółki ST. S.p.A. i są chronione prawami autorskimi – Zabrania się wszelkiego kopiowania bądź modyfikowania, także częściowego, niniejszego dokumentu bez uzyskania stosownej zgody.

PT • As imagens e os conteúdos contidos no presente Manual do Utilizador foram expressamente criados para uso exclusivo da ST. S.p.A., encontrando-se protegidos por direitos de autor. Qualquer tipo de reprodução ou alteração, parcial ou integral, não autorizadas deste Manual estão expressamente proibidas.

RO • Conținutul și imaginile din manualul de utilizare de față au fost realizate în numele ST. S.p.A. și sunt protejate de drepturi de autor – Este interzisă orice reproducere sau modificare chiar și parțială neautorizată a documentului.

RU • Тесты и изображения, содержащиеся в настоящем руководстве, были созданы в интересах ST. S.p.A. и защищены авторскими правами – Любое несанкционированное воспроизведение или изменение документа запрещено.

SK • Obsah a obrázky v tomto návode na používanie boli spracované menom spoločnosti ST. S.p.A. a sú chránené autorským právom – Reprodukcie či nepovolené pozměňovanie tohto dokumentu, a to aj čiastočné, je zakázané.

SL • Vsebine in slike v tem uporabniškem priručniku so izdelane za podjetje ST. S.p.A. in so zaščitene z avtorskimi pravicami – vsakršno nepooblaščenno razmnoževanje ali spreminjanje dokumenta, v celoti ali delno, je prepovedano.

SR • Sadržaj i slike ovog priručnika za upotrebu su napravljeni u ime ST. S.p.A. i zaštićeni su autorskim pravima – Zabranjena je svaka potpuna ili delimična reprodukcija ili izmena dokumenta bez odobrenja.

SV • Innehållet och bilderna i denna användarhandbok har framställts för ST. S.p.A. och skyddas av upphovsrätt – all form av reproduktion eller ändring, även partiell, som inte auktoriserats är förbjuden.

TR • Bu Kullanıcı Kilavuzundaki içerik ve resimler açığa ST. S.p.A. için üretilmiştir ve telif hakkı ile korunmaktadır – dokümanın izinsiz olarak tamamen ya da kısmen herhangi bir şekilde çoğaltılması ya da dağıtılması yasaktır.



	LWA
Type:	dB
Art.N -s/n	
CE	

ST. S.p.A.

Via del Lavoro, 6

31033 Castelfranco Veneto (TV) ITALY